



Lonardi Claudio s.r.l.

Deep drawing – sheet metal forming – 3D/2D laser cutting

V. Pareto, 1-A I-37045 S.Pietro di Legnago (Verona) Italy

Tel.: ++39(0)442-20607 Fax.:++39 (0)442-21545

Web site: www.lonardiclaudio.com E.mail: info@lonardiclaudio.com

CATALOGUE HOUSINGS FOR FILTERS

Revisions

Rev.	Date	Signature	Description
07	02-01-2017	Lonardi	Added canisters with i.d. 117 mm , with i.d. 79.9 mm , with i.d. 75.9 mm , with i.d. 106.00 , with i.d.92.0 mm ; canisters with top seat (page 31)
06	02-01-2015	Lonardi	Added new products and updated graphic
05	15-08-2010	Lonardi	Added new Housings, made new graphic (previous it was rev_04_ 2008)

Housings with inner diameter = 65 mm

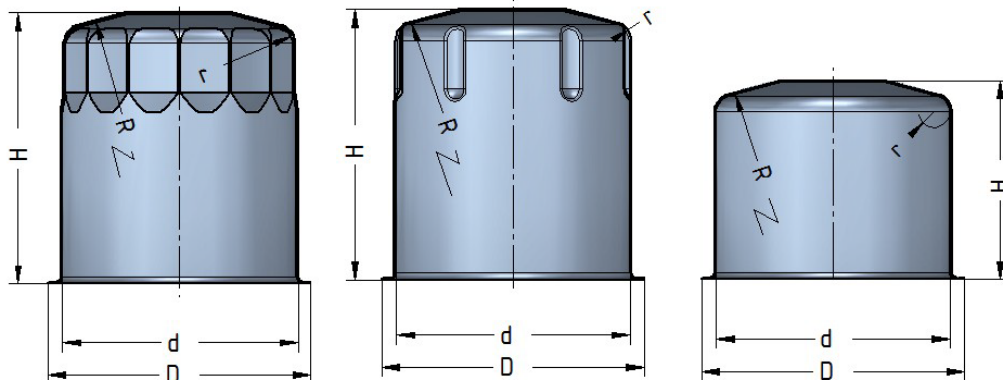

d = inner diameter	D = flange diameter	H = height	S = thickness	R = radius at top	Type of top	N = Number of notches
65 mm	73 mm	49.5 mm	0.5 mm	R = 87.5 mm	Piano d=30	14 Flat notches
65 mm	73 mm	65 mm	0.5 mm	R = 87.5 mm	Piano d=30	14 Flat notches
65 mm	73 mm	75 mm	0.5 mm	R = 87.5 mm	Piano d=30	14 Flat notches
75 mm	83 mm	85 mm	0.5 mm	R = 87.5 mm	Piano d=30	14 Flat notches
65 mm	73 mm	74.5 mm	0.5 mm	R = 87.5 mm	Piano d=30	6 T. tonde
65 mm	73 mm	55 mm	0.5 mm	R = 87.5 mm	Piano d=30	No notches

Materials

DC 05 EN 10130

DX54D+ZA130 EN 10346 (Galfan Z130)

Notes

The shapes of the housings can be changed (Number of notches, radius at the bottom ...)

The height of the housings is modifiable too.

Housings with inner diameter = 74.5 mm

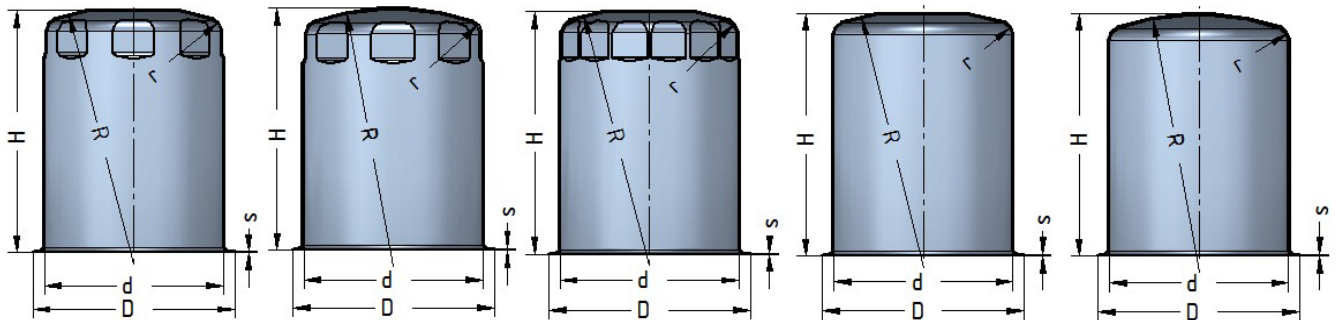

d = inner diameter	D = flange diameter	H = height	S = thickness	R = radius at top	Type of top	N = Number of notches
74.5 mm	83.8 mm	58.4 mm	0.5 mm	R = 106 mm	flat d=40	8 Flat notches
74.5 mm	83.8 mm	68 mm	0.5 mm	R = 106 mm	flat d=40	8 Flat notches
74.5 mm	83.8 mm	72 mm	0.5 mm	R = 106 mm	flat d=40	8 Flat notches
74.5 mm	83.8 mm	84.5 mm	0.5 mm	R = 106 mm	flat d=40	8 Flat notches
74.5 mm	83.8 mm	89 mm	0.5 mm	R = 106 mm	flat d=40	8 Flat notches
74.5 mm	83.8 mm	99 mm	0.5 mm	R = 106 mm	flat d=40	8 Flat notches
74.5 mm	83.8 mm	112 mm	0.5 mm	R = 106 mm	flat d=40	8 Flat notches
74.5 mm	83.8 mm	120 mm	0.5 mm	R = 106 mm	flat d=40	8 Flat notches
74.5 mm	83.8 mm	137.5 mm	0.5 mm	R = 106 mm	flat d=40	8 Flat notches
74.5 mm	83.8 mm	146 mm	0.5 mm	R = 106 mm	flat d=40	8 Flat notches
74.5 mm	83.8 mm	99 mm	0.5 mm	R = 106 mm	All round	8 Flat notches
74.5 mm	83.8 mm	120 mm	0.5 mm	R = 106 mm	All round	8 Flat notches
74.5 mm	83.8 mm	146 mm	0.7 mm	R = 106 mm	All round	8 Flat notches
74.5 mm	83.8 mm	77.5 mm	0.5 mm	R = 106 mm	flat d=40	14 Flat notches
74.5 mm	83.8 mm	89 mm	0.5 mm	R = 106 mm	flat d=40	14 Flat notches
74.5 mm	83.8 mm	120mm	0.6 mm	R = 106 mm	All round	No notches
74.5 mm	83.8 mm	146 mm	0.7 mm	R = 106 mm	All round	No notches
74.5 mm	83.8 mm	72 mm	0.5 mm	R = 106 mm	flat d=40	No notches
74.5 mm	83.8 mm	89 mm	0.5 mm	R = 106 mm	flat d=40	No notches
74.5 mm	83.8 mm	99 mm	0.5 mm	R = 106 mm	flat d=40	No notches

Materials (Housings d=74.5)

DC 05 EN 10130

DX54D+ZA130 EN 10346 (Galfan Z130)

Notes (Housings d=74.5)

The shapes of the housings can be changed (Number of notches, radius at the bottom ...)

The height of the housings is modifiable .

Housings with inner diameter = 75 mm

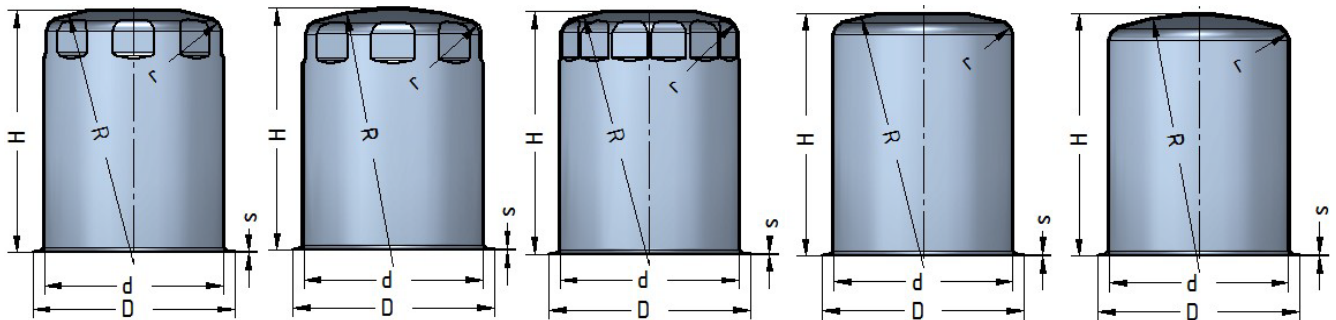

Caratteristiche dimensionali :

d = inner diameter	D = flange diameter	H = height	S = thickness	R = radius at top	Type of top	N = Number of notches
75 mm	83.3 mm	48 mm	0.5 mm	R = 106 mm	Piano d=40	8 Flat notches
75 mm	83.3 mm	54 mm	0.5 mm	R = 106 mm	Piano d=40	8 Flat notches
75 mm	83.3 mm	58.4 mm	0.5 mm	R = 106 mm	Piano d=40	8 Flat notches
75 mm	83.3 mm	68 mm	0.5 mm	R = 106 mm	Piano d=40	8 Flat notches
75 mm	83.3 mm	72 mm	0.5 mm	R = 106 mm	Piano d=40	8 Flat notches
75 mm	83.3 mm	89 mm	0.5 mm	R = 106 mm	Piano d=40	8 Flat notches
75 mm	83.3 mm	99.5 mm	0.5 mm	R = 106 mm	Piano d=40	8 Flat notches
75 mm	83.3 mm	122.5 mm	0.5 mm	R = 106 mm	Piano d=40	8 Flat notches
75 mm	83.3 mm	138 mm	0.5 mm	R = 106 mm	Piano d=40	8 Flat notches
75 mm	83.3 mm	146 mm	0.5 mm	R = 106 mm	Piano d=40	8 Flat notches
75 mm	83.3 mm	167.5 mm	0.5 mm	R = 106 mm	Piano d=40	8 Flat notches
75 mm	83.3 mm	59 mm	0.5 mm	R = 106 mm	All round	8 Flat notches
75 mm	83.3 mm	68 mm	0.5 mm	R = 106 mm	All round	8 Flat notches
75 mm	83.3 mm	106 mm	0.5 mm	R = 106 mm	All round	8 Flat notches
75 mm	83.3 mm	139 mm	0.5 / 0.7 mm	R = 106 mm	All round	8 Flat notches
75 mm	83.3 mm	142 mm	0.5 / 0.7 mm	R = 106 mm	All round	8 Flat notches
75 mm	83.3 mm	168 mm	0.5 mm	R = 106 mm	All round	8 Flat notches
75 mm	83.3 mm	57 mm	0.5 mm	R = 87 mm	All round	12 round not.
75 mm	83.3 mm	77 mm	0.5 mm	R = 87 mm	All round	12 round not.
75 mm	83.3 mm	86.5 mm	0.5 mm	R = 87 mm	All round	12 round not.
75 mm	83.3 mm	98.5 mm	0.5 mm	R = 87 mm	All round	12 round not.
75 mm	83.3 mm	59 mm	0.5 / 0.6 / 0.7	R = 77 mm	All round	No notches
75 mm	83.3 mm	70 mm	0.5 / 0.6 / 0.7	R = 77 mm	All round	No notches
75 mm	83.3 mm	90 mm	0.5 / 0.6 / 0.7	R = 77 mm	All round	No notches
75 mm	83.3 mm	122.5 mm	0.5 / 0.6 / 0.7	R = 77 mm	All round	No notches
75 mm	83.3 mm	138 mm	0.5 / 0.6 / 0.7	R = 77 mm	All round	No notches
75 mm	83.3 mm	146 mm	0.5 / 0.6 / 0.7	R = 77 mm	All round	No notches
75 mm	83.3 mm	78.5 mm	0.5 mm	R = 87 mm	All round	14 Flat notches
75 mm	83.3 mm	68 mm	0.5 mm	R = 80 mm	Piano d = 28	15 Flat notches
75 mm	83.3 mm	138 mm	0.5 mm	R = 80 mm	Piano d = 28	15 Flat notches
75 mm	83.3 mm	146 mm	0.5 mm	R = 80 mm	Piano d = 28	15 Flat notches

Materials (Housings d=75)

DC 05 EN 10130
 DX54D+ZA130 EN 10346 (Galfan Z130)

Notes (Housings d=75)

The shapes of the housings can be changed (Number of notches, radius at the bottom ...)
 The height of the housings is modifiable .

Housings with inner diameter= 75.9 mm

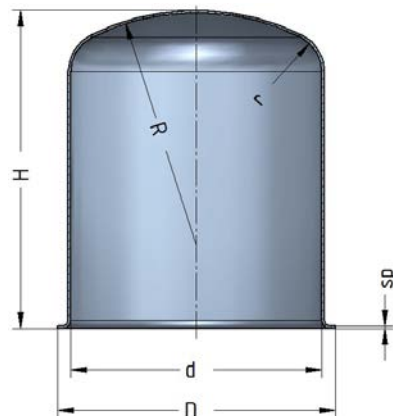

d = inner diameter	D = flange diameter	H = height	S = thickness	R = radius at top	Type of top	N = Number of notches
75.9 mm	84 mm	81 mm	0.5/0.6 mm	R = 73 mm	All round	No notches
75.9 mm	84 mm	119 mm	0.5/0.6 mm	R = 73 mm	All round	No notches
75.9 mm	84 mm	131 mm	0.5/0.6 mm	R = 73 mm	All round	No notches

Materials (Housings d=75.9)

DC 05 EN 10130
 DX54D+ZA130 EN 10346 (Galfan Z130)

Notes (Housings d=75.9)

The shapes of the housings can be changed (number of notches, radius at the bottom ...)
 The height of the housings is modifiable .

Housings with inner diameter= 79 mm

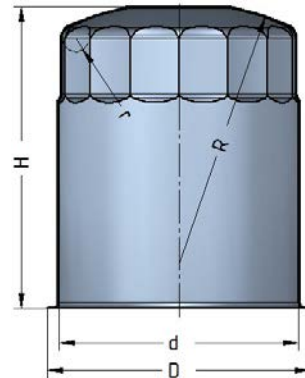

d = inner diameter	D = flange diameter	H = height	S = thickness	R = radius at top	Type of top	N = Number of notches
79 mm	87 mm	69.5 mm	0.5 mm	R = 87.5 mm	Piano d=35	15 Flat notches
79 mm	87 mm	73 mm	0.5 mm	R = 87.5 mm	Piano d=35	15 Flat notches
79 mm	87 mm	79.5 mm	0.5 mm	R = 87.5 mm	Piano d=35	15 Flat notches
79 mm	87 mm	89.5 mm	0.5 mm	R = 87.5 mm	Piano d=35	15 Flat notches
79 mm	87 mm	100 mm	0.5 mm	R = 87.5 mm	Piano d=35	15 Flat notches
79 mm	87 mm	119.5 mm	0.5 mm	R = 87.5 mm	Piano d=35	15 Flat notches

Materials (Housings d=79)

DC 05 EN 10130

DX54D+ZA130 EN 10346 (Galfan Z130)

Notes (Housings d=79)

(**) available shape with hole d=25 mm at the top

The shapes of the housings can be changed (number of notches, radius at the bottom ...)

The height of the housings is modifiable .

Housings with inner diameter= 79 mm

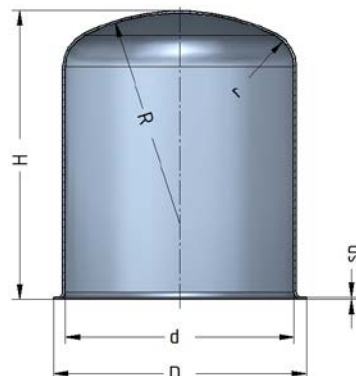

d = inner diameter	D = flange diameter	H = height	S = thickness	R = radius at top	Type of top	N = Number of notches
79 mm	87.3 mm	80 mm	0.7 / 0.8 mm	R = 73 mm	All round	No notches
79 mm	87.3 mm	100 mm	0.7 / 0.8 mm	R = 73 mm	All round	No notches
79 mm	87.3 mm	118 mm	0.7 / 0.8 mm	R = 73 mm	All round	No notches
79 mm	87.3 mm	138 mm	0.7 / 0.8 mm	R = 73 mm	Piano d=35	No notches

Materials (Housings d=79)

DC 05 EN 10130
DX54D+ZA130 EN 10346 (Galfan Z130)

Notes (Housings d=79)

The shapes of the housings can be changed (number of notches, radius at the bottom ...)
The height of the housings is modifiable .

Housings with inner diameter= 79.9 mm

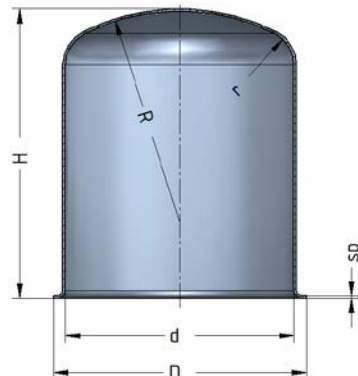

d = inner diameter	D = flange diameter	H = height	S = thickness	R = radius at top	Type of top	N = Number of notches
79.9 mm	88.0 mm	85 mm	0.5/0.6 mm	R = 73 mm	All round	No notches
79.9 mm	88.0 mm	119 mm	0.5/0.6 mm	R = 73 mm	All round	No notches
79.9 mm	88.0 mm	175 mm	0.5/0.6 mm	R = 73 mm	All round	No notches

Materials (Housings d=79.9)

DC 05 EN 10130
DX54D+ZA130 EN 10346 (Galfan Z130)

Notes (Housings d=79.9)

The shapes of the housings can be changed (number of notches, radius at the bottom ...)
The height of the housings is modifiable .

Housings with inner diameter 83/79 mm

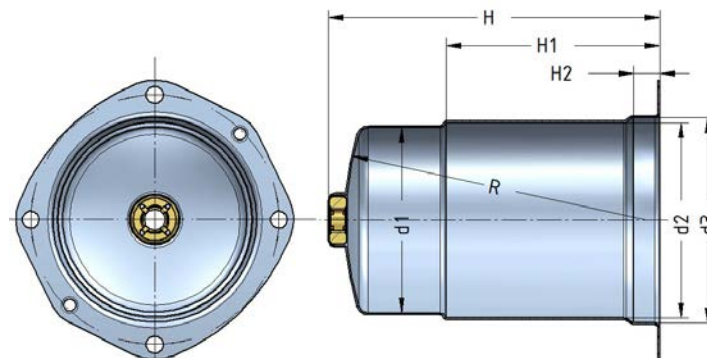

Caratteristiche dimensionali :

d2 = inner diameter	d3 = inner diameter	d1 = top diameter	H = Total height	S= thickness	R = Radius at top	Nut thread
83 mm	79 mm	75 mm	135 mm	0.7 mm	R = 125 mm	M10

Materials (Housings d=83/79)

Housing : DX54D+ZA255 EN10346 / DX54D+ZA130 10346

Insert : polyamide 6.6 or zinc coated iron

Housings with inner diameter= 82/79 mm

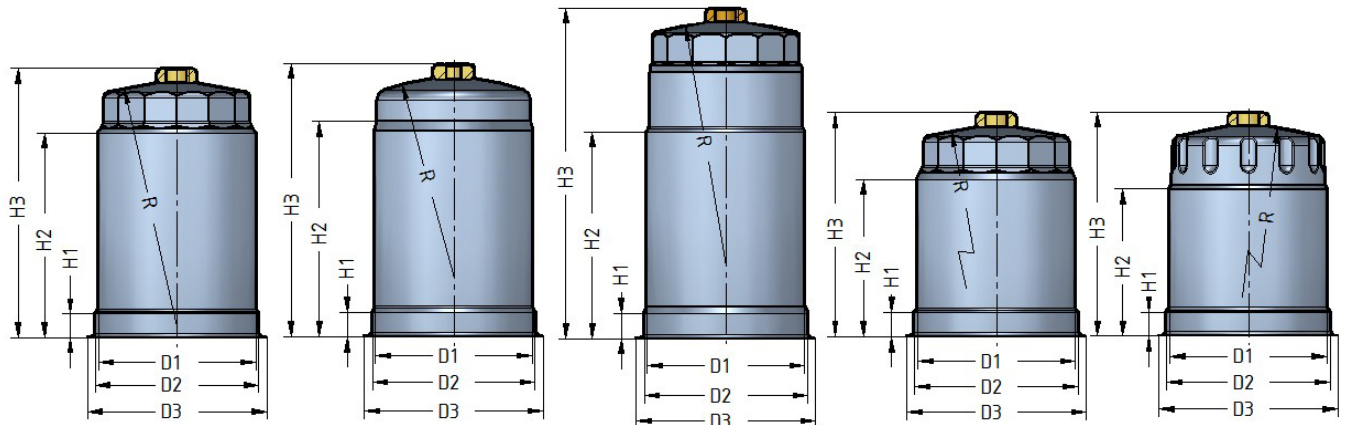

Caratteristiche dimensionali :

D1 = inner diameter	D2 = Inner diameter	D3 = Flange diameter	S = thickness	R = radius at top	H3 = Total height	number of notches
79 mm	81.8 mm	90 mm	0.5/0.6 mm	R = 122 mm	109.5 mm	14 Flat notches
79 mm	81.8 mm	90 mm	0.5/0.6 mm	R = 122 mm	134.5 mm	14 Flat notches
79 mm	81.8 mm	90 mm	0.5/0.6 mm	R = 122 mm	165.5 mm	14 Flat notches
79 mm	81.8 mm	90 mm	0.5/0.6 mm	R = 122 mm	109.5 mm	12 Flat notches
79 mm	81.8 mm	90 mm	0.5/0.6 mm	R = 130 mm	112.5 mm	14 Flat notches
79 mm	81.8 mm	90 mm	0.5/0.6 mm	R = 122 mm	136.5 mm	No notches

Materials (Housings d=82)

DX54D+ZA130 EN 10346 (Galfan Z130)

Nuts (Housings d=82/79)

- Nut M8 polyamide 6.6
- Nut M8 zinc coated iron
- Nut M10 zinc coated iron
- Nut M10 polyamide 6.6
- Nut M12x1.75 zinc coated iron (normal thread pitch)
- Nut M12x1.5 zinc coated iron (fine thread pitch)

Notes (Housings d=82/79)

The shapes of the housings can be changed (number of notches, radius at the bottom ...)
The height of the housings is modifiable .

Housings with inner diameter = 83/79 mm

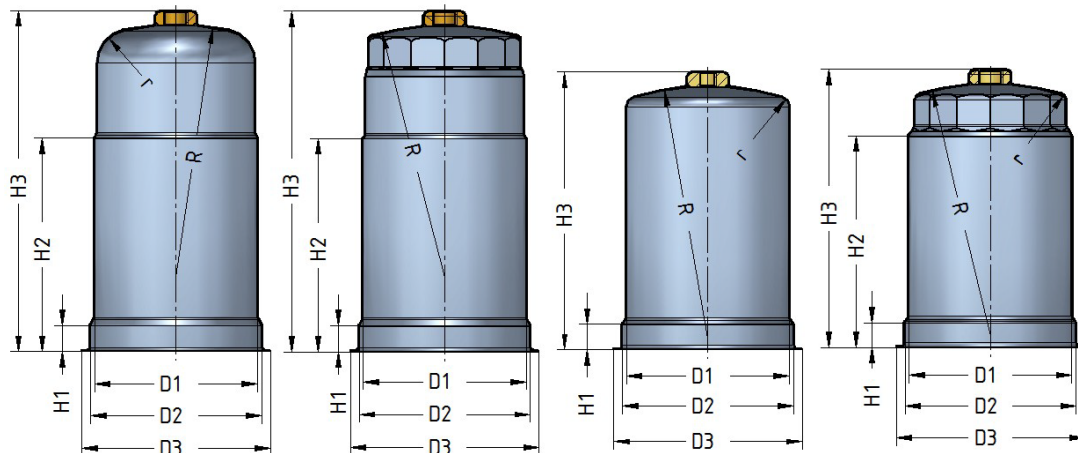

Caratteristiche dimensionali :

D1 = inner diameter	D2 = Inner diameter	D3 = Flange diameter	S = thickness	R = radius at top	H3 = Total height	number of notches
79 mm	83 mm	91.5 mm	0.5/0.6 mm	R = 122 mm	80 mm	14 Flat notches
79 mm	83 mm	91.5 mm	0.5/0.6 mm	R = 122 mm	134.5 mm	14 Flat notches
79 mm	83 mm	91.5 mm	0.5/0.6 mm	R = 122 mm	165 mm	14 Flat notches
79 mm	83 mm	91.5 mm	0.5/0.6 mm	R = 122 mm	134.5 mm	No notches
79 mm	83 mm	91.5 mm	0.5/0.6 mm	R = 122 mm	162 mm	No notches

Materials (Housings d=83/79)

DX54D+ZA130 EN 10346 (Galfan Z130)

Nuts (Housings d=83/79)

Nut M8 polyamide 6.6
 Nut M8 zinc coated iron
 Nut M10 zinc coated iron
 Nut M10 polyamide 6.6
 Nut M12x1.75 zinc coated iron (normal thread pitch)
 Nut M12x1.5 zinc coated iron (fine thread pitch)

Notes (Housings d=83/79)

The shapes of the housings can be changed (number of notches, radius at the bottom ...)
 The height of the housings is modifiable .

Housings with inner diameter= 83 mm

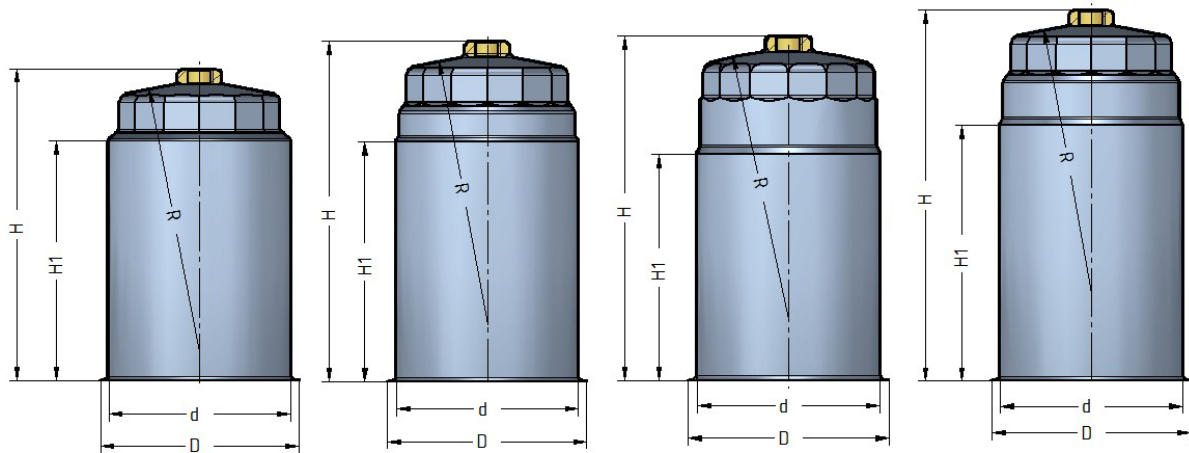

d = inner diameter	D3 = flange diameter	S = thickness	R = radius at top	H = total height	H1 = height	Number of notches
83 mm	91.5 mm	0.5/0.6 mm	R = 122 mm	142 mm	109 mm	14 Flat notches
83 mm	91.5 mm	0.5/0.6 mm	R = 122 mm	155 mm	109 mm	14 Flat notches
83 mm	91.5 mm	0.5/0.6 mm	R = 122 mm	157 mm	103 mm	14 Flat notches
83 mm	91.5 mm	0.5/0.6 mm	R = 122 mm	169 mm	117 mm	No notches

Materials (Housings d=83)

DX54D+ZA130 EN 10346 (Galfan Z130)

Nuts (Housings d=83)

Nut M8 polyamide 6.6
 Nut M8 zinc coated iron
 Nut M10 zinc coated iron
 Nut M10 polyamide 6.6
 Nut M12x1.75 zinc coated iron (normal thread pitch)
 Nut M12x1.5 zinc coated iron (fine thread pitch)

Notes (Housings d=83)

The shapes of the housings can be changed (number of notches, radius at the bottom ...)
 The height of the housings is modifiable .

Housings no flange and inner diameter = 84.5/79 mm

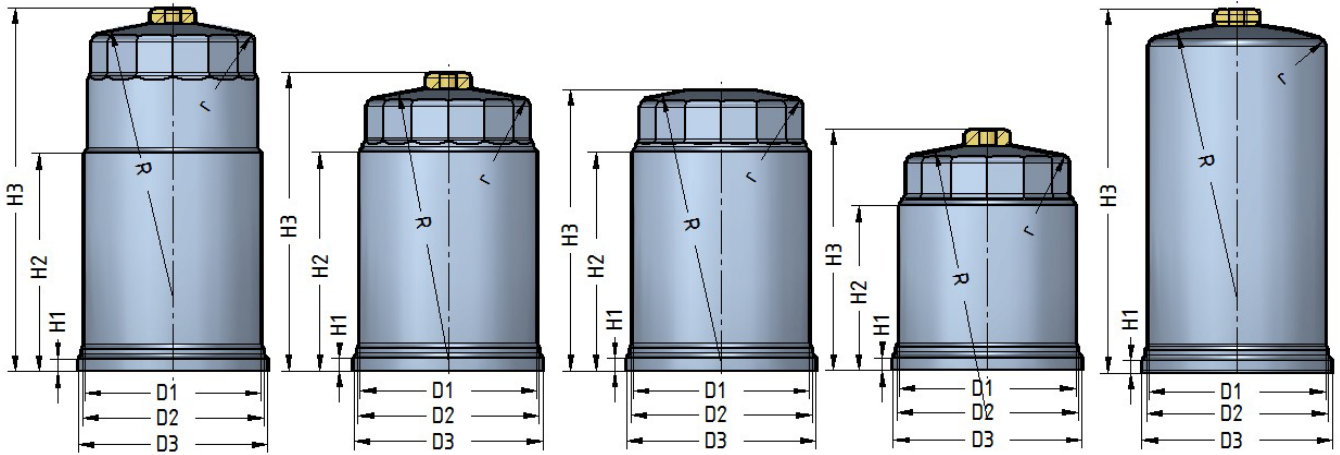

D1 = inner diameter	D2 = Inner diameter	D3 = Flange diameter	S = thickness	R = radius at top	H3 = Total height	number of notches
79 mm	81 mm	84.5 mm	0.7 mm	R = 122 mm	107 mm	14 Flat notches
79 mm	81 mm	84.5 mm	0.7 mm	R = 122 mm	132.8 mm	14 Flat notches
79 mm	81 mm	84.5 mm	0.7 mm	R = 122 mm	162 mm	14 Flat notches
79 mm (*)	81 mm	84.5 mm	0.7 mm	R = 122 mm	125 mm	14 Flat notches
79 mm	81 mm	84.5 mm	0.7 mm	R = 122 mm	162 mm	No notches

Materials (Housings d=84.5)

DX54D+ZA130 EN 10346 (Galfan Z130)

Nuts (Housings d=84.5)

Nut M8 polyamide 6.6
 Nut M8 zinc coated iron
 Nut M10 zinc coated iron
 Nut M10 polyamide 6.6
 Nut M12x1.75 zinc coated iron (normal thread pitch)
 Nut M12x1.5 zinc coated iron (fine thread pitch)

Notes (Housings d=84.5)

(*) without nut
 The shapes of the housings can be changed (number of notches, radius at the bottom ...)
 The height of the housings is modifiable .

Housings with inner diameter= 83 mm

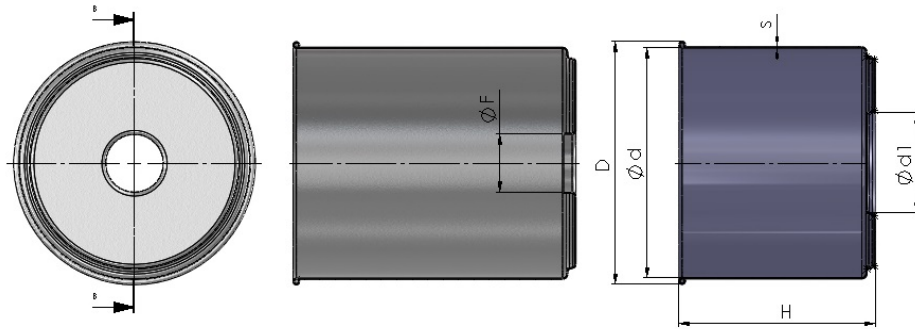

d = inner diameter	D = Flange diameter	S = thickness	F = hole	H = Total height		Number of notches
83 mm	88 mm	0.4 mm	//	71.5 mm		No notches
83 mm	88 mm	0.4 mm	21 mm	103 mm		No notches
83 mm	88 mm	0.4 mm	//	111.4 mm		No notches

Materials (Housings d=83)

DC 05 EN 10130
 DX54D+ZA130 EN 10346 (Galfan Z130)

Notes (Housings d=83)

The shapes of the housings can be changed (number of notches, radius at the bottom ...)
 The height of the housings is modifiable .

Housings with inner diameter= 85.7 mm

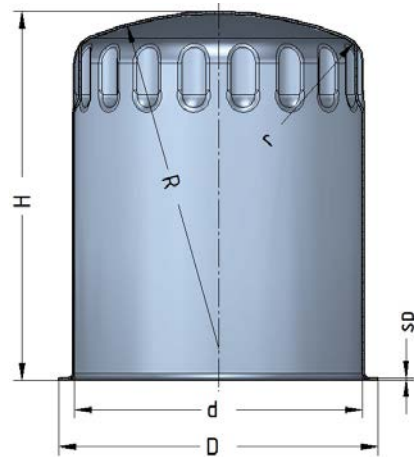

d = inner diameter	D = flange diameter	H = height	S = thickness	R = radius at top	Type of top	N = Number of notches
85.7 mm	95 mm	58.4 mm	0.5 / 0.6 mm	R = 100 mm	All round	18 round not.
85.7 mm	95 mm	67 mm	0.5 / 0.6 mm	R = 100 mm	All round	18 round not.
85.7 mm	95 mm	75.5 mm	0.5 / 0.6 mm	R = 100 mm	All round	18 round not.
85.7 mm	95 mm	88.5 mm	0.5 / 0.6 mm	R = 100 mm	All round	18 round not.
85.7 mm	95 mm	96 mm	0.5 / 0.6 mm	R = 100 mm	All round	18 round not.
85.7 mm	95 mm	100 mm	0.5 / 0.6 mm	R = 100 mm	All round	18 round not.
85.7 mm	95 mm	117 mm	0.5 / 0.6 mm	R = 100 mm	All round	18 round not.
85.7 mm	95 mm	139 mm	0.5 / 0.6 mm	R = 100 mm	All round	18 round not.

Materials (Housings d=85.7)

DC 05 EN 10130
 DX54D+ZA130 EN 10346 (Galfan Z130)

Notes (Housings d=85.7)

The shapes of the housings can be changed (number of notches, radius at the bottom ...)
 The height of the housings is modifiable .

Housings with inner diameter= 86 mm

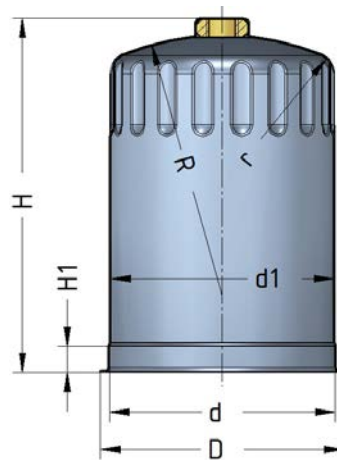

d = inner diameter	D = flange diameter	H = height	S = thickness	R = Radius at top	d1 = 2° diameter	Number of notches
86 mm	93 mm	136 mm	0.5 / 0.6 mm	R = 100 mm	85 mm	18 round not.
86 mm	93 mm	160 mm	0.5 / 0.6 mm	R = 100 mm	85 mm	18 round not.

Materials (Housings d=86)

DC 05 EN 10130
 DX54D+ZA130 EN 10346 (Galfan Z130)
 Nut M8 polyamide 6.6
 Nut M8 zinc coated iron
 Nut M10 zinc coated iron
 Nut M10 polyamide 6.6
 Nut M12x1.75 zinc coated iron (normal thread pitch)
 Nut M12x1.5 zinc coated iron (fine thread pitch)

Notes (Housings d=86)

(*) r = radius = 8 mm.
 (**) H1 = 10 mm
 The shapes of the housings can be changed (number of notches, radius at the bottom ...)
 The height of the housings is modifiable .

Housings with inner diameter = 86.5 mm

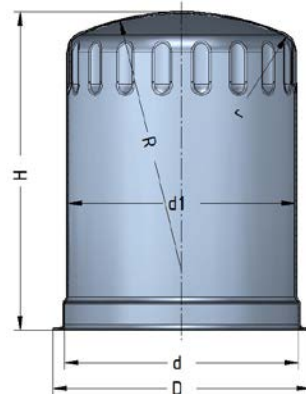

d = inner diameter	D = flange diameter	H = height	S = thickness	R = radius at top	d1 = 2° diameter	Number of notches
86.5 mm	95.2 mm	48 mm	0.5 / 0.6 mm	R = 95 mm	85 mm	18 round not.
86.5 mm	95.2 mm	67 mm	0.5 / 0.6 mm	R = 95 mm	85 mm	18 round not.
86.5 mm	95.2 mm	92 mm	0.5 / 0.6 mm	R = 95 mm	85 mm	18 round not.
86.5 mm	95.2 mm	104 mm	0.5 / 0.6 mm	R = 95 mm	85 mm	18 round not.
86.5 mm	95.2 mm	117 mm	0.5 / 0.6 mm	R = 95 mm	85 mm	18 round not.
86.5 mm	95.2 mm	120.5 mm	0.5 / 0.6 mm	R = 95 mm	85 mm	18 round not.
86.5 mm	95.2 mm	138.5 mm	0.5 / 0.6 mm	R = 95 mm	85 mm	18 round not.

Materials (Housings d=86.5)

DC 05 EN 10130

DX54D+ZA130 EN 10346 (Galfan Z130)

Notes (Housings d=86.5)

(*) r = radius = 7 mm. (**) H1 = 6.5 mm

The shapes of the housings can be changed (number of notches, radius at the bottom ...)

The height of the housings is modifiable .

Housings with inner diameter = 89/95 mm

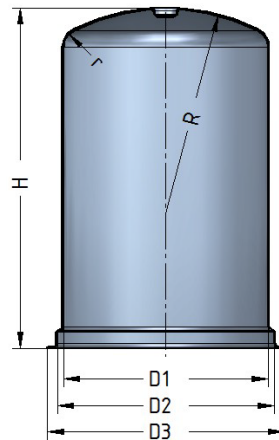

D1 = inner diameter	D2 = flange diameter	H = height	S = thickness	R = Radius at top	Type of top	Number of notches
89.6 mm	95 mm	109 mm	0.7 mm	R = 90 mm	All round	No notches
89.6 mm	95 mm	133 mm	0.7 mm	R = 90 mm	All round	No notches
89.6 mm	95 mm	182 mm	0.7 mm	R = 90 mm	All round	No notches

Materials (Housings d=95)

DC 05 EN 10130

DX54D+ZA130 EN 10346 (Galfan Z130)

Notes (Housings d=95)

The shapes of the housings can be changed (number of notches, radius at the bottom ...)

The height of the housings is modifiable .

Housings with inner diameter= 90 mm

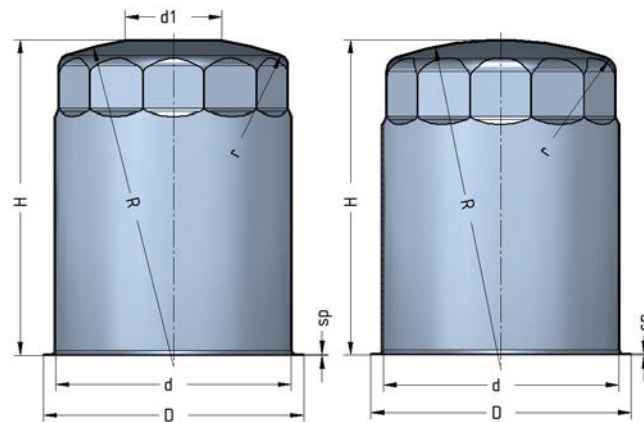

Caratteristiche dimensionali :

d = inner diameter	D = flange diameter	H = height	S = thickness	R = radius at top	Type of top	N = Number of notches
90 mm	99.5 mm	64.5 mm	0.5 / 0.6 mm	R = 125 mm	Piano d=37	12 Flat notches
90 mm	99.5 mm	68 mm	0.5 / 0.6 mm	R = 125 mm	Piano d=37	12 Flat notches
90 mm	99.5 mm	78.5 mm	0.5 / 0.6 mm	R = 125 mm	Piano d=37	12 Flat notches
90 mm	99.5 mm	99 mm	0.5 / 0.6 mm	R = 125 mm	Piano d=37	12 Flat notches
90 mm	99.5 mm	85 mm	0.5 / 0.6 mm	R = 125 mm	All round	12 Flat notches
90 mm	99.5 mm	95 mm	0.5 / 0.6 mm	R = 125 mm	All round	12 Flat notches
90 mm	99.5 mm	107 mm	0.5 / 0.6 mm	R = 125 mm	All round	12 Flat notches
90 mm	99.5 mm	170 mm	0.5 / 0.6 mm	R = 125 mm	All round	12 Flat notches
90 mm	99.5 mm	140 mm	0.5 / 0.6 mm	R = 125 mm	All round	12 Flat notches
90 mm	99.5 mm	191 mm	0.5 / 0.6 mm	R = 125 mm	All round	12 Flat notches
90 mm	99.5 mm	210 mm	0.5 / 0.6 mm	R = 125 mm	All round	12 Flat notches

Materials (Housings d=90)

DC 05 EN 10130

DX54D+ZA130 EN 10346 (Galfan Z130)

Notes (Housings d=90)

(*) r = raggio raccordo = 7 mm.

The shapes of the housings can be changed (number of notches, radius at the bottom ...)

The height of the housings is modifiable .

Housings with inner diameter= 91.8 mm

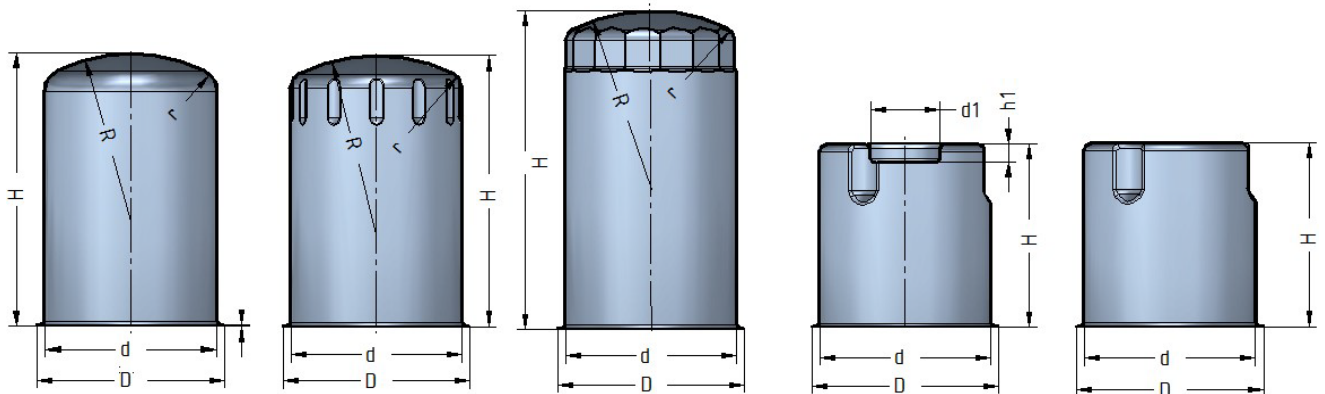

d = inner diameter	D = flange diameter	H = height	S = thickness	R = radius at top	Type of top	N = Number of notches
91.8 mm	100.2 mm	103 mm	0.7 / 0.8 mm	R = 89 mm	All round	No notches
91.8 mm	100.2 mm	140 mm	0.7 / 0.8 mm	R = 89 mm	All round	No notches
91.8 mm	100.2 mm	170 mm	0.7 / 0.8 mm	R = 89 mm	All round	No notches
91.8 mm	100.2 mm	210 mm	0.7 / 0.8 mm	R = 89 mm	All round	No notches
91.8 mm	100.4 mm	144 mm	0.5 / 0.6 mm	R = 95 mm	All round	15 Flat notches
91.8 mm	100.4 mm	170 mm	0.5 / 0.6 mm	R = 95 mm	All round	15 Flat notches
91.8 mm	100.4 mm	210 mm	0.5 / 0.6 mm	R = 95 mm	All round	15 Flat notches
91.8 mm	100.4 mm	100 mm	0.5 / 0.6 mm	R = 95 mm	All round	12 Round not.
91.8 mm	100.4 mm	144 mm	0.5 / 0.6 mm	R = 95 mm	All round	12 Round not.
91.8 mm	100.4 mm	170 mm	0.5 / 0.6 mm	R = 95 mm	All round	12 Round not.
91.8 mm	100.4 mm	210 mm	0.5 / 0.6 mm	R = 95 mm	All round	12 Round not.
91.8 mm	100.4 mm	98 mm	0.6 mm	Piano	With seat	2 round +1 flat
91.8 mm	100.4 mm	98 mm	0.6 mm	Piano	Without seat	2 round +1 flat

Materials (Housings d=91.8)

DC 05 EN 10130

DX54D+ZA130 EN 10346 (Galfan Z130)

Notes (Housings d=91.8)

The shapes of the housings can be changed (number of notches, radius at the bottom ...)

The height of the housings is modifiable .

Housings with inner diameter= 92.0 mm

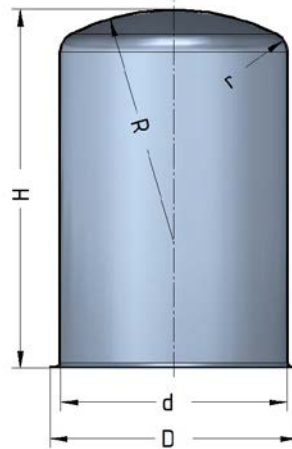

d = inner diameter	D = flange diameter	H = height	S = thickness	R = radius at top	Type of top	N = Number of notches
92.0 mm	100.1 mm	91 mm	0.5 / 0.6 mm	R =89 mm	All round	No notches
92.0 mm	100.1 mm	99 mm	0.5 / 0.6 mm	R =89 mm	All round	No notches
92.0 mm	100.1 mm	110 mm	0.5 / 0.6 mm	R =89 mm	All round	No notches
92.0 mm	100.1 mm	138 mm	0.5 / 0.6 mm	R =89 mm	All round	No notches
92.0 mm	100.1 mm	140.5 mm	0.5 / 0.6 mm	R =89 mm	All round	No notches
92.0 mm	100.1 mm	172 mm	0.5 / 0.6 mm	R =89 mm	All round	No notches
92.0 mm	100.1 mm	208 mm	0.5 / 0.6 mm	R =89 mm	All round	No notches
92.0 mm	100.1 mm	232 mm	0.5 / 0.6 mm	R =89 mm	All round	No notches
92.0 mm	100.1 mm	264 mm	0.5 / 0.6 mm	R =89 mm	All round	No notches

Materials (Housings d=92)

DC 05 EN 10130

DX54D+ZA130 EN 10346 (Galfan Z130)

Notes (Housings d=92)

(*) r = radius = 12 mm.

The shapes of the housings can be changed (number of notches, radius at the bottom ...)

The height of the housings is modifiable .

Housings with inner diameter= 94 mm

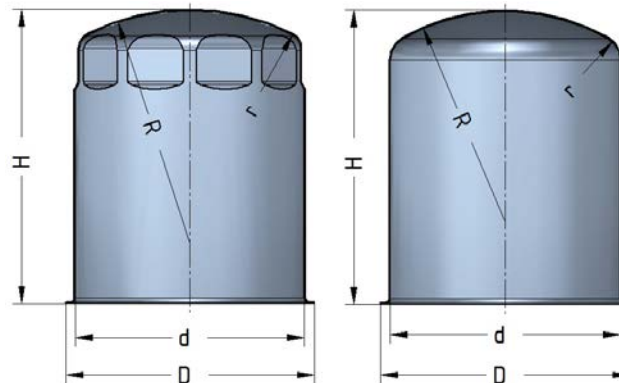

d = inner diameter	D = flange diameter	H = height	S = thickness	R = radius at top	Type of top	N = Number of notches
94 mm	102.3 mm	65 mm	0.5 / 0.6 mm	R = 95 mm	All round	10 flat notches
94 mm	102.3 mm	94 mm	0.5 / 0.6 mm	R = 95 mm	All round	10 flat notches
94 mm	102.3 mm	138 mm	0.5 / 0.6 mm	R = 95 mm	All round	10 flat notches
94 mm	102.3 mm	178 mm	0.5 / 0.6 mm	R = 95 mm	All round	10 flat notches
94 mm	102.3 mm	209 mm	0.5 / 0.6 mm	R = 95 mm	All round	10 flat notches
94 mm	102.3 mm	94 mm	0.5/0.6/0.7mm	R = 86 mm	All round	No notches
94 mm	102.3 mm	109 mm	0.5/0.6/0.7mm	R = 86 mm	All round	No notches
94 mm	102.3 mm	145 mm	0.5/0.6/0.7mm	R = 86 mm	All round	No notches
94 mm	102.3 mm	170 mm	0.5/0.6/0.7mm	R = 86 mm	All round	No notches
94 mm	102.3 mm	209 mm	0.5/0.6/0.7mm	R = 86 mm	All round	No notches

Materials (Housings d=94)

DC 05 EN 10130

DX54D+ZA130 EN 10346 (Galfan Z130)

Notes (Housings d=94)

(*) r = radius = 8-10 mm.

The shapes of the housings can be changed (number of notches, radius at the bottom ...)

The height of the housings is modifiable .

Housings with inner diameter= 94.5 mm

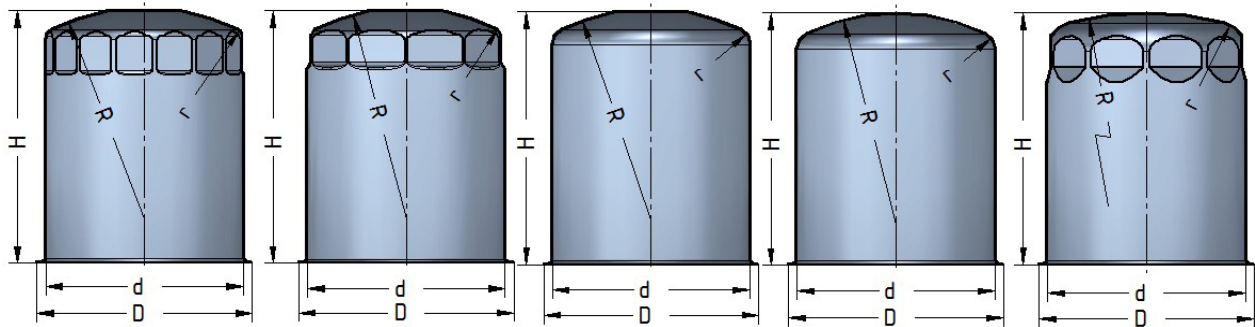

d = inner diameter	D = flange diameter	H = height	S = thickness	R = radius at top	Type of top	N = Number of notches
94.5 mm	103 mm	56.8 mm	0.5 / 0.6 mm	R = 100 mm	Piano d=36	15 Flat notches
94.5 mm	103 mm	126.4 mm	0.5 / 0.6 mm	R = 100 mm	Piano d=36	15 Flat notches
94.5 mm	103 mm	138.5 mm	0.5 / 0.6 mm	R = 100 mm	Piano d=36	15 Flat notches
94.5 mm	103 mm	143.5 mm	0.5 / 0.6 mm	R = 100 mm	Piano d=36	15 Flat notches
94.5 mm	103 mm	165.5 mm	0.5 / 0.6 mm	R = 100 mm	Piano d=36	15 Flat notches
94.5 mm	103 mm	172.5 mm	0.5 / 0.6 mm	R = 100 mm	Piano d=36	15 Flat notches
94.5 mm	103 mm	190 mm	0.5 / 0.6 mm	R = 100 mm	Piano d=36	15 Flat notches
94.5 mm	103 mm	84.5 mm	0.5 / 0.6 mm	R = 100 mm	Piano d=36	10 flat notches
94.5 mm	103 mm	94.5 mm	0.5 / 0.6 mm	R = 100 mm	Piano d=36	10 flat notches
94.5 mm	103 mm	108 mm	0.5 / 0.6 mm	R = 100 mm	Piano d=36	10 flat notches
94.5 mm	103 mm	138 mm	0.5 / 0.6 mm	R = 100 mm	Piano d=36	10 flat notches
94.5 mm	103 mm	56.8 mm	0.5 / 0.6 mm	R = 100 mm	Piano d=36	No notches
94.5 mm	103 mm	165 mm	0.5 / 0.6 mm	R = 100 mm	Piano d=36	No notches
94.5 mm	103 mm	56.8 mm	0.5 / 0.6 mm	R = 100 mm	Tutta tonda	No notches
94.5 mm	103 mm	94 mm	0.5 / 0.6 mm	R = 100 mm	Tutta tonda	No notches
94.5 mm	103 mm	143.4 mm	0.5 / 0.6 mm	R = 100 mm	Tutta tonda	No notches
94.5 mm	103 mm	190 mm	0.5 / 0.6 mm	R = 100 mm	Tutta tonda	No notches
94.5 mm	103 mm	58 mm	0.5/0.6/0.7mm	R = 86 mm	Tutta tonda	No notches
94.5 mm	103 mm	94 mm	0.5/0.6/0.7mm	R = 86 mm	Tutta tonda	No notches
94.5 mm	103 mm	145 mm	0.5/0.6/0.7mm	R = 86 mm	Tutta tonda	No notches
94.5 mm	103 mm	172 mm	0.5/0.6/0.7mm	R = 86 mm	Tutta tonda	No notches
94.5 mm	103 mm	206 mm	0.5/0.6/0.7mm	R = 86 mm	Tutta tonda	No notches
94.5 mm	103 mm	172.5 mm	0.5 / 0.6 mm	R = 150 mm	Tutta tonda	10 flat notches
94.5 mm	103 mm	191.5 mm	0.5 / 0.6 mm	R = 150 mm	Tutta tonda	10 flat notches

Materials (Housings d=94.5)

DC 05 EN 10130

DX54D+ZA130 EN 10346 (Galfan Z130)

Notes (Housings d=94.5)

The shapes of the housings can be changed (number of notches, radius at the bottom ...)

The height of the housings is modifiable .

Housings with inner diameter 94 mm and M5 inserts

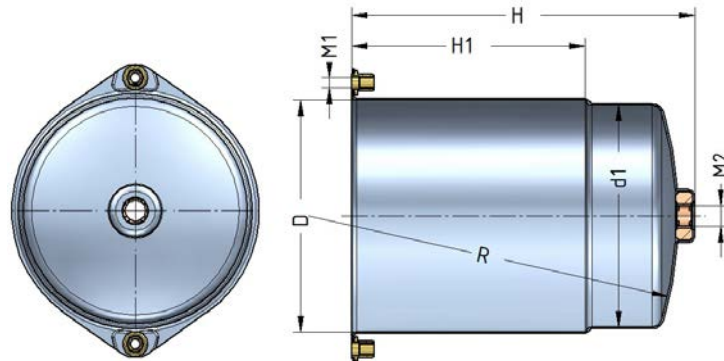

D = Inner diameter	D1 = Body diameter	M2 thread of the nut	H = height	S = thickness	R = Radius of the top	M1 Insert thread
94 mm	90 mm	M10	140	0.7 mm	R = 150 mm	M5

Materials (Housings d=94 +M5)

Withtenitore: DX54D+ZA255 EN10346 / DX54D+ZA130 EN346

Nut M10 : polyamide 6.6

Inserti M5 : zinc coated iron

Housings with inner diameter 94 mm and special flange

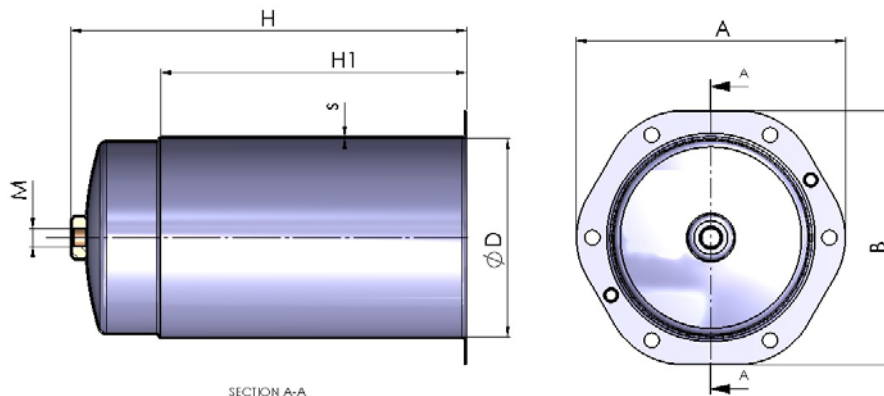

D = inner diameter	D1 = body diameter	S= thckiness	H = height	H1 = height 1	A = flange	B = flange
94 mm	90 mm	0.7	187	144 mm	127 mm	120

Materials (Housings d=94 + special flange)

Withtenitore: DX54D+ZA255 EN10346 / DX54D+ZA130 EN346

Nut M8 polyamide 6.6

Nut M8 zinc coated iron

Nut M10 zinc coated iron

Nut M10 polyamide 6.6

Nut M12x1.75 zinc coated iron (normal thread pitch)

Nut M12x1.5 zinc coated iron (fine thread pitch)

Housings with inner diameter= 105 mm

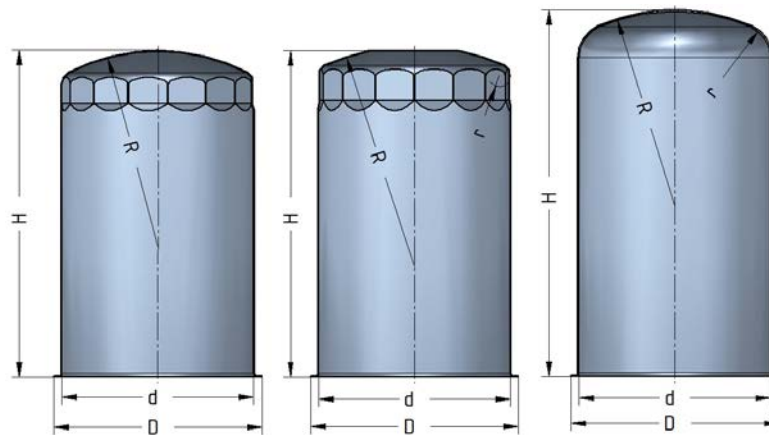

d = inner diameter	D = flange diameter	H = height	S = thickness	R = radius at top	Type of top	N = Number of notches
105 mm	114 mm	95 mm	0.5 / 0.6 mm	R = 106 mm	All round	15 Flat notches
105 mm	114 mm	138 mm	0.5 / 0.6 mm	R = 106 mm	All round	15 Flat notches
105 mm	114 mm	174 mm	0.5 / 0.6 / 0.7	R = 106 mm	All round	15 Flat notches
105 mm	114 mm	178 mm	0.5 / 0.6 mm	R = 106 mm	All round	15 Flat notches
105 mm	114 mm	210 mm	0.6 / 0.7 mm	R = 106 mm	All round	15 Flat notches
105 mm	114 mm	220 mm	0.6 / 0.7 mm	R = 106 mm	All round	15 Flat notches
105 mm	114 mm	230 mm	0.6 / 0.7 mm	R = 106 mm	All round	15 Flat notches
105 mm	114 mm	261 mm	0.6 / 0.7 mm	R = 106 mm	All round	15 Flat notches
105 mm	114 mm	95 mm	0.5 / 0.6 mm	R = 120 mm	Piano d=50	15 Flat notches
105 mm	114 mm	138 mm	0.5 / 0.6 mm	R = 120 mm	Piano d=50	15 Flat notches
105 mm	114 mm	178 mm	0.5 / 0.6 mm	R = 120 mm	Piano d=50	15 Flat notches
105 mm	114 mm	138 mm	0.5 / 0.6 mm	R = 106 mm	All round	No notches
105 mm	114 mm	178 mm	0.5/0.6/0.7mm	R = 106 mm	All round	No notches
105 mm	114 mm	210 mm	0.7 mm	R = 106 mm	All round	No notches
105 mm	114 mm	230 mm	0.7 mm	R = 106 mm	All round	No notches
105 mm	114 mm	260 mm	0.7 mm	R = 106 mm	All round	No notches

Materials (Housings d=105)

DC 05 EN 10130

DX54D+ZA130 EN 10346 (Galfan Z130)

Notes (Housings d=105)

The shapes of the housings can be changed (number of notches, radius at the bottom ...)

The height of the housings is modifiable .

Housings with inner diameter = 106.0 mm

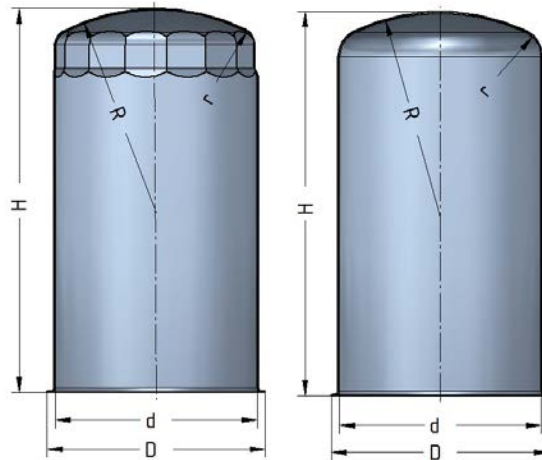

d = inner diameter	D = flange diameter	H = height	S = thickness	R = radius at top	Type of top	N = Number of notches
106.0 mm	115.7 mm	210 mm	0.7 mm	R = 114 mm	All round	No notches
106.0 mm	115.7 mm	230 mm	0.7 mm	R = 114 mm	All round	No notches
106.0 mm	115.7 mm	261 mm	0.7 mm	R = 114 mm	All round	No notches

Materials (Housings d=106.0)

DC 05 EN 10130

DX54D+ZA130 EN 10346 (Galfan Z130)

Notes (Housings d=106.0)

The shapes of the housings can be changed (number of notches, radius at the bottom ...)

The height of the housings is modifiable .

Housings with inner diameter = 106.5 mm

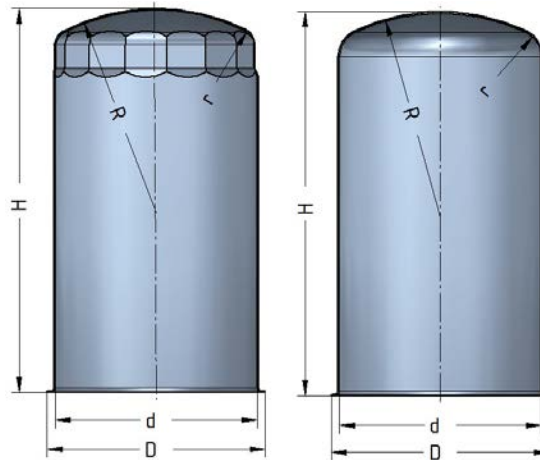

d = inner diameter	D = flange diameter	H = height	S = thickness	R = radius at top	Type of top	N = Number of notches
106.5 mm	114.8 mm	95 mm	0.5 / 0.6 mm	R = 106 mm	All round	15 Flat notches
106.5 mm	114.8 mm	138 mm	0.5 / 0.6 mm	R = 106 mm	All round	15 Flat notches
106.5 mm	114.8 mm	178 mm	0.5 / 0.6 mm	R = 106 mm	All round	15 Flat notches
106.5 mm	114.8 mm	183 mm	0.5 / 0.6 mm	R = 106 mm	All round	15 Flat notches
106.5 mm	114.8 mm	210 mm	0.6 / 0.7 mm	R = 106 mm	All round	15 Flat notches
106.5 mm	114.8 mm	229 mm	0.6 / 0.7 mm	R = 106 mm	All round	15 Flat notches
106.5 mm	114.8 mm	252.5 mm	0.6 / 0.7 mm	R = 106 mm	All round	15 Flat notches
106.5 mm	114.8 mm	261 mm	0.6 / 0.7 mm	R = 106 mm	All round	15 Flat notches
106.5 mm	114.8 mm	299 mm	0.6 / 0.7 mm	R = 106 mm	All round	15 Flat notches
106.5 mm	114.8 mm	210 mm	0.6 / 0.7 mm	R = 106 mm	All round	No notches
106.5 mm	114.8 mm	230 mm	0.6 / 0.7 mm	R = 106 mm	All round	No notches
106.5 mm	114.8 mm	261 mm	0.6 / 0.7 mm	R = 106 mm	All round	No notches
106.5 mm	114.8 mm	299 mm	0.6 / 0.7 mm	R = 106 mm	All round	No notches

Materials (Housings d=106.5)

DC 05 EN 10130

DX54D+ZA130 EN 10346 (Galfan Z130)

Notes (Housings d=106.5)

The shapes of the housings can be changed (number of notches, radius at the bottom ...)

The height of the housings is modifiable .

Housings with inner diameter = 107 mm

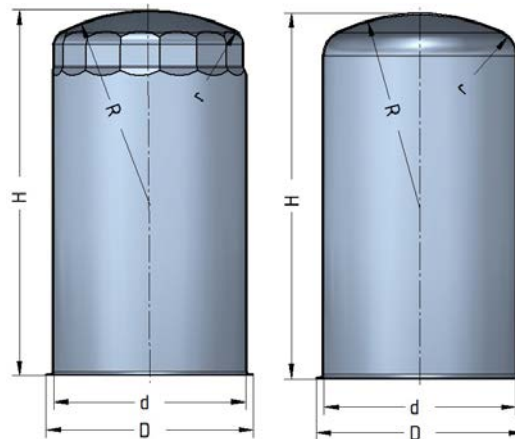

d = inner diameter	D = flange diameter	H = height	S = thickness	R = radius at top	Type of top	N = Number of notches
107 mm	115.6 mm	95 mm	0.5 / 0.6 mm	R = 106 mm	All round	15 Flat notches
107 mm	115.6 mm	110 mm	0.5 / 0.6 mm	R = 106 mm	All round	15 Flat notches
107 mm	115.6 mm	123 mm	0.5 / 0.6 mm	R = 106 mm	All round	15 Flat notches
107 mm	115.6 mm	143 mm	0.5 / 0.6 mm	R = 106 mm	All round	15 Flat notches
107 mm	115.6 mm	178 mm	0.5 / 0.6 mm	R = 106 mm	All round	15 Flat notches
107 mm	115.6 mm	183 mm	0.5 / 0.6 mm	R = 106 mm	All round	15 Flat notches
107 mm	115.6 mm	210 mm	0.6 / 0.7 mm	R = 106 mm	All round	15 Flat notches
107 mm	115.6 mm	229 mm	0.6 / 0.7 mm	R = 106 mm	All round	15 Flat notches
107 mm	115.6 mm	252.5 mm	0.6 / 0.7 mm	R = 106 mm	All round	15 Flat notches
107 mm	115.6 mm	259 mm	0.6 / 0.7 mm	R = 106 mm	All round	15 Flat notches
107 mm	115.6 mm	210 mm	0.6 / 0.7 mm	R = 106 mm	All round	No notches
107 mm	115.6 mm	230 mm	0.6 / 0.7 mm	R = 106 mm	All round	No notches
107 mm	115.6 mm	259 mm	0.6 / 0.7 mm	R = 106 mm	All round	No notches
d = inner diameter	D = flange diameter	H = height	S = thickness	R = radius at top	Type of top	N = Number of notches
107 mm	117 mm	95 mm	0.5 / 0.6 mm	R = 125 mm	All round	15 Flat notches
107 mm	117 mm	111 mm	0.5 / 0.6 mm	R = 125 mm	All round	15 Flat notches
107 mm	117 mm	138 mm	0.5 / 0.6 mm	R = 125 mm	All round	15 Flat notches
107 mm	117 mm	176 mm	0.5 / 0.6 mm	R = 125 mm	All round	15 Flat notches
107 mm	117 mm	183 mm	0.5 / 0.6 mm	R = 125 mm	All round	15 Flat notches
107 mm	117 mm	210 mm	0.6 / 0.7 mm	R = 125 mm	All round	15 Flat notches
107 mm	117 mm	229 mm	0.6 / 0.7 mm	R = 125 mm	All round	15 Flat notches
107 mm	117 mm	252.5 mm	0.6 / 0.7 mm	R = 125 mm	All round	15 Flat notches
107 mm	117 mm	259 mm	0.6 / 0.7 mm	R = 125 mm	All round	15 Flat notches
107 mm	115.6 mm	143 mm	0.5 / 0.6 mm	R = 125 mm	All round	No notches
107 mm	115.6 mm	210 mm	0.6 / 0.7 mm	R = 106 mm	All round	No notches
107 mm	115.6 mm	230 mm	0.6 / 0.7 mm	R = 106 mm	All round	No notches
107 mm	115.6 mm	259 mm	0.6 / 0.7 mm	R = 106 mm	All round	No notches

Materials (Housings d=107)

DC 05 EN 10130
 DX54D+ZA130 EN 10346 (Galfan Z130)

Notes (Housings d=107)

The shapes of the housings can be changed (number of notches, radius at the bottom ...)
 The height of the housings is modifiable .

Housings with inner diameter = 117.0 mm

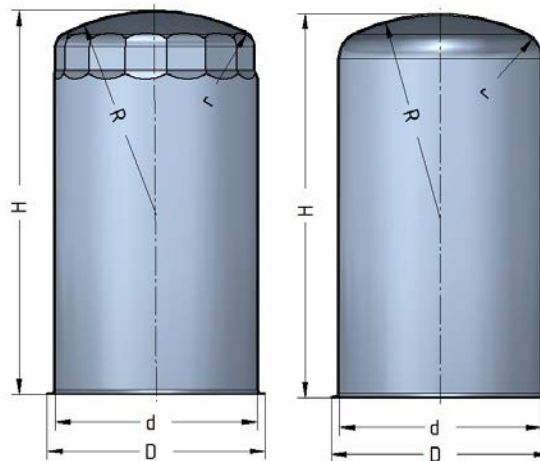

d = inner diameter	D = flange diameter	H = height	S = thickness	R = radius at top	Type of top	N = Number of notches
117.0 mm	126.7 mm	198 mm	0.7 mm	R = 148 mm	All round	No notches
117.0 mm	126.7 mm	259 mm	0.7 mm	R = 148 mm	All round	No notches
117.0 mm	126.7 mm	297 mm	0.7 mm	R = 148 mm	All round	No notches

Materials (Housings d=117)

DC 05 EN 10130
 DX54D+ZA130 EN 10346 (Galfan Z130)

Notes (Housings d=117)

The shapes of the housings can be changed (number of notches, radius at the bottom ...)
 The height of the housings is modifiable .

Housings with inner diameter = 118.6 mm

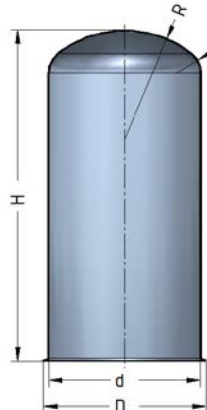

d = inner diameter	D = flange diameter	H = height	S = thickness	R = radius at top	Type of top	N = Number of notches
118.6 mm	127 mm	257 mm	0.7 mm	R = 85 mm	All round	No notches

Materials (Housings d=118.6)

DC04 EN 10130 --- DX54D+ZA130 EN 10346 (Galfan Z130)

Notes (Housings d=118.6)

The shapes of the housings can be changed (number of notches, radius at the bottom ...)

The height of the housings is modifiable .

Housings with coaxial hole

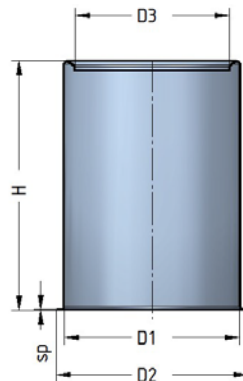

d = inner diameter	D = flange diameter	H = height	S = thickness	D3 = Hole at the top	N = Number of notches
92.2 mm	101 mm	102mm	0.5 / 0.6 mm	81.1 mm	No notches
92.2 mm	101 mm	132 mm	0.5 / 0.6 mm	81.1 mm	No notches
106.5 mm	114.8	155.6	0.6 mm	98.9 mm	No notches
106.5 mm	114.8	217.6	0.6 mm	98.9 mm	No notches

Materials (Housings with foro largo)

DX54D+ZA130 EN 10346 (Galfan Z130)

Notes (Housings with foro largo)

The shapes of the housings can be changed (number of notches, radius at the bottom ...)

The height of the housings is modifiable .

Housings with M36 plastic insert

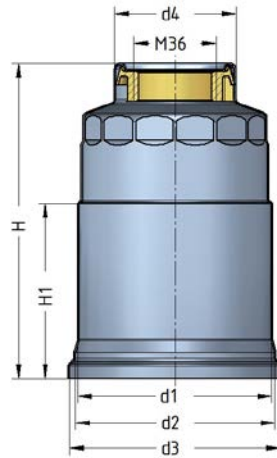

d1 = diam. interno	d2 = diam. Interno	d3 = diam. interno	S = spessore	H = altezza	d4 = diam. sede	Filetto inserto
84 mm	87 mm	92 mm	0.6 mm	H = 138	53 mm	M36

Materials (Housings with Nut M36)

Vasca DX54D+ZA130 EN 10346 (Galfan Z130)

Nut Polyamide 6.6

Housings with inserts on the top

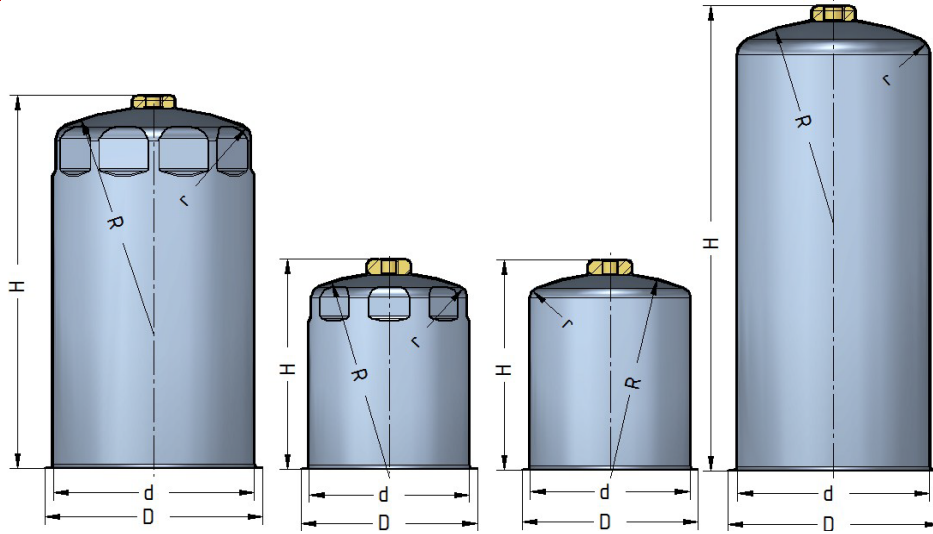

d = inner diameter	D = flange diameter	H = height	S = thickness	R = radius at top	N = Number of notches
75 mm	83.3 mm	87 mm	0.5 / 0.6 mm	R = 95 mm	8 Flat notches
75 mm	83.3 mm	97.2 mm	0.5/0.6 mm	R = 95 mm	8 Flat notches
75 mm	83.3 mm	93 mm	0.5/0.6 mm	R = 85 mm	12 Round n.
75 mm	83.3 mm	120 mm	0.5/0.6 mm	R = 95 mm	No notches
75 mm	83.3 mm	137 mm	0.5/0.6 mm	R = 95 mm	No notches
90 mm	99.5 mm	217 mm	0.5/0.6 mm	R = 95 mm	No notches
94 mm	102.3 mm	107mm	0.5/0.6 mm	R = 95 mm	10 flat notches
94 mm	102.3 mm	143mm	0.5/0.6 mm	R = 95 mm	10 flat notches
94 mm	102.3 mm	175 mm	0.5/0.6 mm	R = 95 mm	10 flat notches
94 mm	102.3 mm	183 mm	0.5/0.6 mm	R = 95 mm	10 flat notches
106.5 mm	114.8 mm	217 mm	0.7 mm	R = 106 mm	No notches

Materials (Housings with inserts)

DX54D+ZA130 EN 10346 (Galfan Z130)

Type of nuts (Housings with inserts)

Nut M8 polyamide 6.6
 Nut M8 zinc coated iron
 Nut M10 zinc coated iron
 Nut M10 polyamide 6.6
 Nut M12x1.75 zinc coated iron (normal thread pitch)
 Nut M12x1.5 zinc coated iron (fine thread pitch)
 Nut M14x2 zinc coated iron

Notes (Housings with inserts)

The shapes of the housings can be changed (number of notches, radius at the bottom ...)
 The height of the housings is modifiable .

Housings with a seat on the top

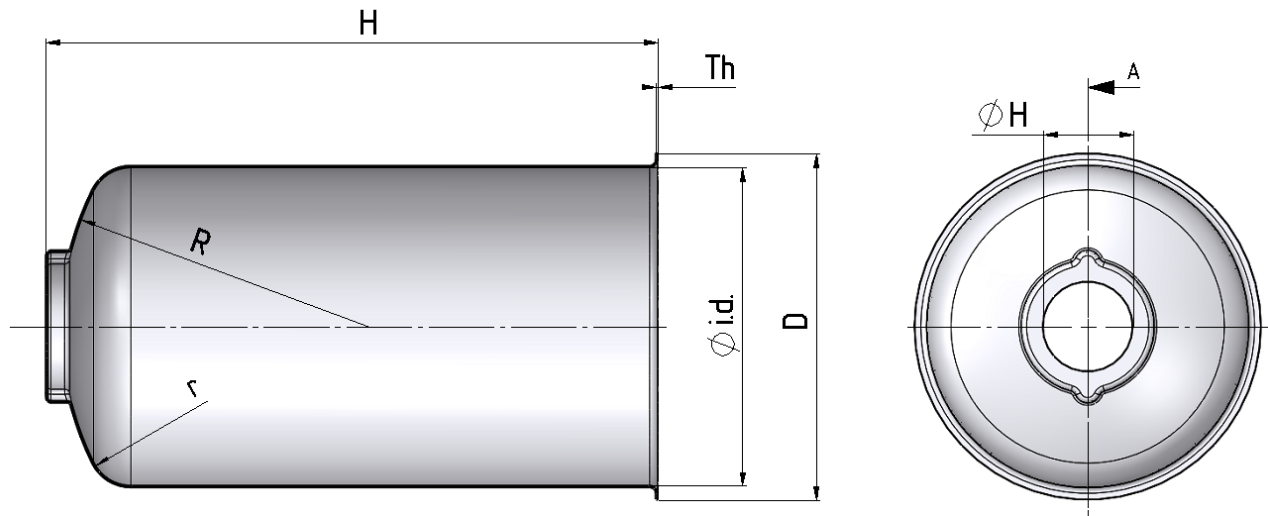

d = inner diameter	D = flange diameter	H = height	S = thickness	R = radius at top	Top Hole H	N = Number of notches
75.9 mm	84 mm	131 mm	0.5/ 0.6 mm	R =89 mm	26 mm	No notches
92.0 mm	100.1 mm	110 mm	0.5/ 0.6 mm	R =89 mm	26 mm	No notches
92.0 mm	100.1 mm	138 mm	0.5/ 0.6 mm	R =89 mm	26 mm	No notches
92.0 mm	100.1 mm	177 mm	0.5/ 0.6 mm	R =89 mm	26 mm	No notches
106 mm	115.7 mm	227 mm	0.7 mm	R =89 mm	26 mm	No notches

Materials (Housings with top seat)

DX54D+ZA130 EN 10346 (Galfan Z130)

Type of nuts (Housings with top seat)

No nut

Notes (Housings with top seat)

The shapes of the housings can be changed (number of notches, radius at the bottom ...)
The height of the housings is modifiable .

Housings with inner diameter = 124 mm

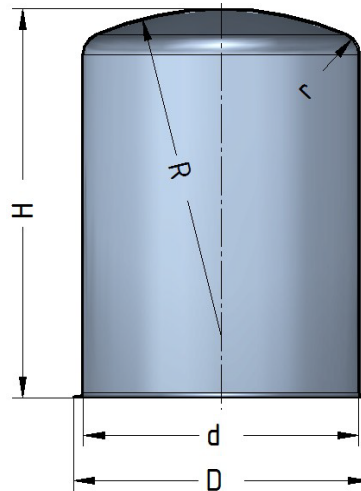

d = inner diameter	D = flange diameter	H = height	S = thickness	R = radius at top	Type of top	N = Number of notches
124 mm	134 mm	100 mm	0.7mm	R = 160mm	Piano d=32	No notches
124 mm	134 mm	160 mm	0.7 mm	R = 160mm	Piano d=32	No notches
124 mm	134 mm	176 mm	0.7 mm	R = 160mm	Piano d=32	No notches
124 mm	134 mm	179 mm	0.7 mm	R = 160mm	Piano d=32	No notches
124 mm	134 mm	225 mm	0.7 mm	R = 160mm	Piano d=32	No notches
124 mm	134 mm	235 mm	0.7 mm	R = 160mm	Piano d=32	No notches

Materials (Housings d=124)

DC 05 EN 10130

DX54D+ZA130 EN 10346 (Galfan Z130)

Notes (Housings d=124)

The shapes of the housings can be changed (number of notches, radius at the bottom ...)

The height of the housings is modifiable .

Housings with inner diameter = 125.5 mm

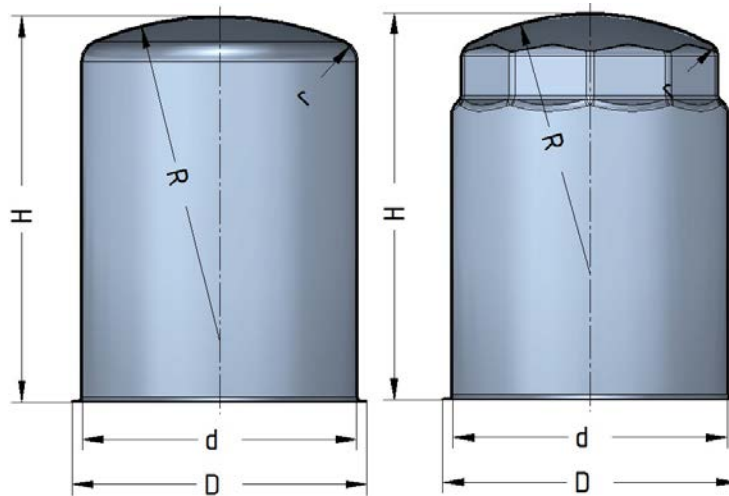

d = inner diameter	D = flange diameter	H = height	S = thickness	R = radius at top	Type of top	N = Number of notches
125.5 mm	135 mm	100 mm	0.7mm	R = 138 mm	Piano d=29	No notches
125.5 mm	135 mm	160 mm	0.7 mm	R = 138 mm	Piano d=29	No notches
125.5 mm	135 mm	176 mm	0.7 mm	R = 138 mm	Piano d=29	No notches
125.5 mm	135 mm	179 mm	0.7 mm	R = 138 mm	Piano d=29	No notches
125.5 mm	135 mm	225 mm	0.7 mm	R = 138 mm	Piano d=29	No notches
125.5 mm	135 mm	235 mm	0.7 mm	R = 138 mm	Piano d=29	No notches
125.5 mm	135 mm	280 mm	0.7 mm	R = 138 mm	Piano d=29	No notches
125.5 mm	135 mm	310 mm	0.7 mm	R = 138 mm	Piano d=29	No notches
125.5 mm	135 mm	100 mm	0.7 mm	R = 138 mm	All round	10 flat notches
125.5 mm	135 mm	176 mm	0.7 mm	R = 138 mm	All round	10 flat notches
125.5 mm	135 mm	179 mm	0.7 mm	R = 138 mm	All round	10 flat notches
125.5 mm	135 mm	225 mm	0.7 mm	R = 138 mm	All round	10 flat notches

Materials (Housings d=125.5)

DC 05 EN 10130

DX54D+ZA130 EN 10346 (Galfan Z130)

Notes (Housings d=125.5)

The shapes of the housings can be changed (number of notches, radius at the bottom ...)

The height of the housings is modifiable .

Housings with inner diameter = 127.5 mm

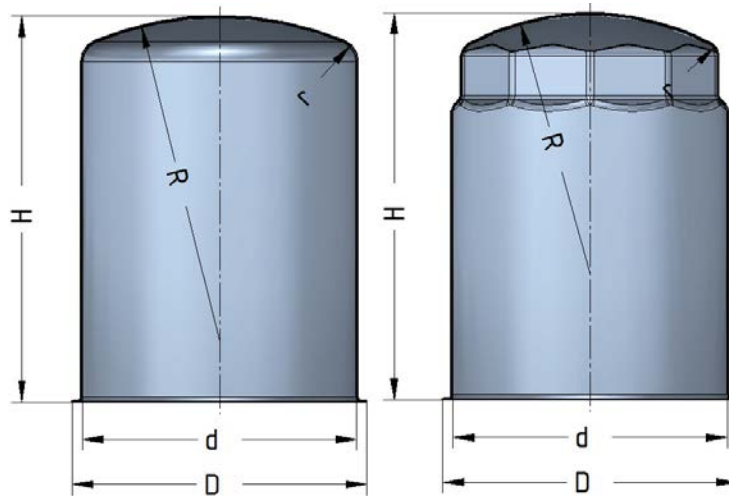

d = inner diameter	D = flange diameter	H = height	S = thickness	R = radius at top	Type of top	N = Number of notches
127.5 mm	137 mm	100 mm	0.7mm	R = 150 mm	All round	No notches
127.5 mm	137 mm	160 mm	0.7 mm	R = 150 mm	All round	No notches
127.5 mm	137 mm	176 mm	0.7 mm	R = 150 mm	All round	No notches
127.5 mm	137 mm	179 mm	0.7 mm	R = 150 mm	All round	No notches
127.5 mm	137 mm	225 mm	0.7 mm	R = 150 mm	All round	No notches
127.5 mm	137 mm	235 mm	0.7 mm	R = 150 mm	All round	No notches
127.5 mm	137 mm	280 mm	0.7 mm	R = 150 mm	All round	No notches
127.5 mm	137 mm	310 mm	0.7 mm	R = 150 mm	All round	No notches
127.5 mm	137 mm	100 mm	0.7 mm	R = 120 mm	All round	10 flat notches
127.5 mm	137 mm	176 mm	0.7 mm	R = 120 mm	All round	10 flat notches
127.5 mm	137 mm	179 mm	0.7 mm	R = 120 mm	All round	10 flat notches
127.5 mm	137 mm	225 mm	0.7 mm	R = 120 mm	All round	10 flat notches

Materials (Housings d=127.5)

DC 05 EN 10130

DX54D+ZA130 EN 10346 (Galfan Z130)

Notes (Housings d=127.5)

The shapes of the housings can be changed (number of notches, radius at the bottom ...)

The height of the housings is modifiable .

Housings with inner diameter = 133.7 mm

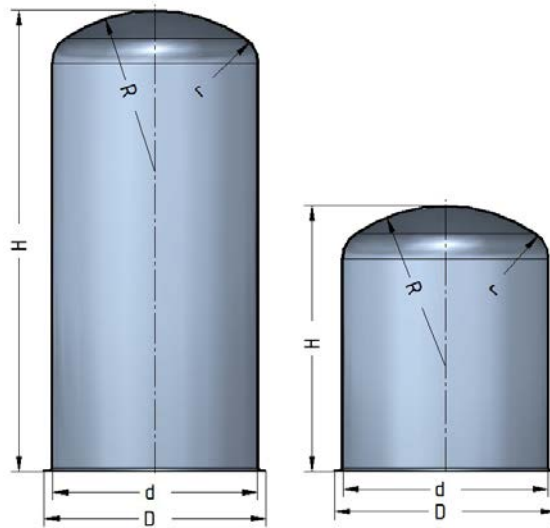

d = inner diameter	D = flange diameter	H = height	S = thickness	R = radius at top	Type of top	N = Number of notches
133.7 mm	145.5 mm	100 mm	1.2 mm	R = 148 mm	All round	No notches
133.7mm	145.5 mm	172 mm	1.2 mm	R = 148 mm	All round	No notches
133.7mm	145.5 mm	235 mm	1.2 mm	R = 148 mm	All round	No notches
133.7mm	145.5 mm	305 mm	1.2 mm	R = 148 mm	All round	No notches
133.7mm	145.5 mm	172 mm	0.8 mm	R = 148 mm	All round	No notches
133.7mm	145.5 mm	235 mm	0.8 mm	R = 148 mm	All round	No notches
133.7mm	145.5 mm	245 mm	1.2 mm	R = 148 mm	All round	No notches
133.7mm	145.5 mm	305 mm	0.8 mm	R = 148 mm	All round	No notches

Materials (Housings d=133.7)

DC 05 EN 10130

DX54D+ZA130 EN 10346 (Galfan Z130)

Notes (Housings d=133.7)

The shapes of the housings can be changed (number of notches, radius at the bottom ...)

The height of the housings is modifiable .

Housings with inner diameter= 134.7 mm

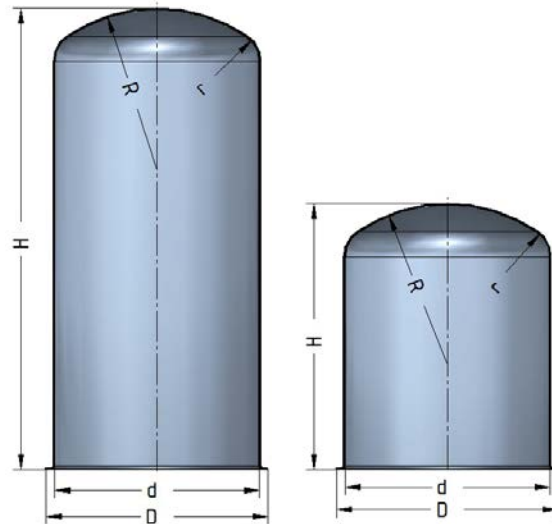

d = inner diameter	D = flange diameter	H = height	S = thickness	R = radius at top	Type of top	N = Number of notches
134.7 mm	147 mm	100 mm	0.8 mm	R = 136 mm	All round	No notches
134.7mm	147 mm	168 mm	1.0 mm	R = 136 mm	All round	No notches
134.7mm	147 mm	172 mm	0.8 mm	R = 136 mm	All round	No notches
134.7mm	147 mm	235 mm	0.8 mm	R = 136 mm	All round	No notches
134.7mm	147 mm	305 mm	0.8 mm	R = 136 mm	All round	No notches
134.7mm	147 mm	305 mm	1.0 mm	R = 136 mm	All round	No notches

Materials (Housings d=134.7)

DC 05 EN 10130
DX54D+Z100 EN 10346
DX54D+ZA130 EN 10346 (Galfan Z130)

Notes (Housings d=134.7)

The shapes of the housings can be changed (number of notches, radius at the bottom ...)
The height of the housings is modifiable .

Housings with inner diameter = 135.7 mm

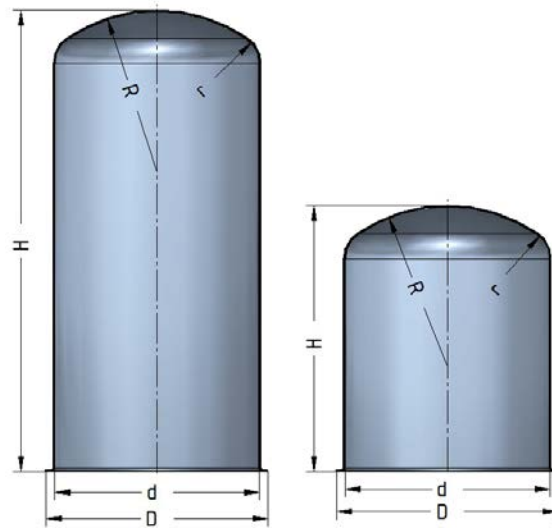

d = inner diameter	D = flange diameter	H = height	S = thickness	R = radius at top	Type of top	N = Number of notches
135.7 mm	147 mm	100 mm	0.8mm	R = 106 mm	All round	No notches
135.7mm	147 mm	172 mm	0.8 mm	R = 106 mm	All round	No notches
135.7mm	147 mm	235 mm	0.8 mm	R = 106 mm	All round	No notches
135.7mm	147 mm	305 mm	0.8 mm	R = 106 mm	All round	No notches
135.7mm	147 mm	340 mm	0.8 mm	R = 106 mm	All round	No notches

Materials (Housings d=135.7)

DC 05 EN 10130
 DX54D+ZA130 EN 10346 (Galfan Z130)

Notes (Housings d=135.7)

The shapes of the housings can be changed (number of notches, radius at the bottom ...)
 The height of the housings is modifiable .

Housings without flange + i.diam. 81/84 mm thick. 1.2 mm

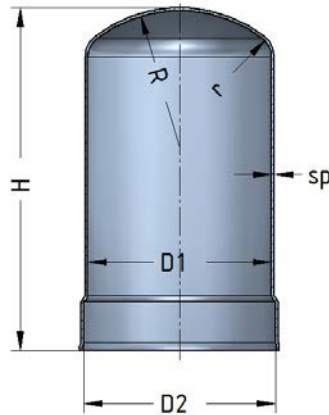

D1 = inner diameter	D2 = inner diameter	H = height	Sp = thickness	R = radius at top	Type of top	N = Number of notches
81 mm	84.3 mm	149.5 mm	1.2 mm	R = 60 mm	All round	No notches

Materials (Housings d=81/84)

DC 05 EN 10130

Notes (Housings d=81/84)

The shapes of the housings can be changed (number of notches, radius at the bottom ...)

The height of the housings is modifiable .

Housings without flange + i. diameter 92/94 mm th. 1.2

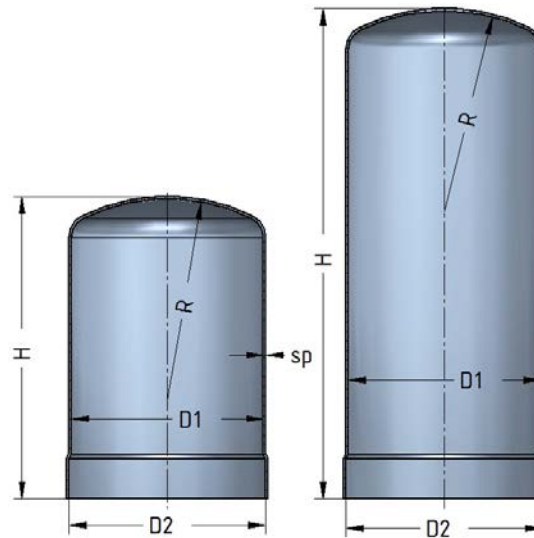

D1 = inner diameter	D2 = inner diameter 2	H = height	S = thickness	R = radius at top	Type of top	N = Number of notches
92 mm	94 mm	89.5 mm	1.2 mm	R =95/ 113	All round	No notches
92 mm	94 mm	103.5 mm	1.2 mm	R =95/ 113	All round	No notches
92 mm	94 mm	128 mm	1.2 mm	R =95/ 113	All round	No notches
92 mm	94 mm	143 mm	1.2 mm	R =95/ 113	All round	No notches
92 mm	94 mm	158.5 mm	1.2 mm	R =95/ 113	All round	No notches
92 mm	94 mm	160 mm	1.2 mm	R =95/ 113	All round	No notches
92 mm	94 mm	187 mm	1.2 mm	R =95/ 113	All round	No notches
92 mm	94 mm	232 mm	1.2 mm	R =95/ 113	All round	No notches
92 mm	94 mm	246 mm	1.2 mm	R =95/ 113	All round	No notches

Materials (Housings d=92/94)

DC 05 EN 10130

Notes (Housings d=92/94)

The shapes of the housings can be changed (number of notches, radius at the bottom ...)

The height of the housings is modifiable .

Housings without flange + i. diameter 90.5/92.7mm th. 1.2

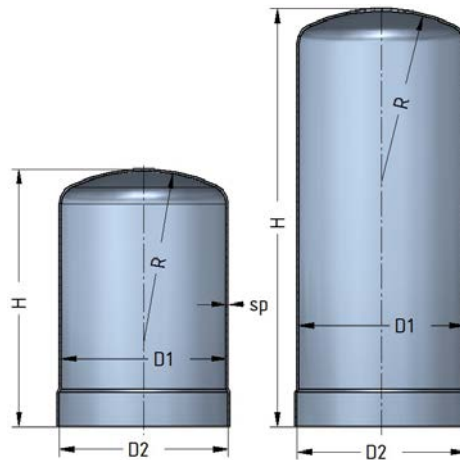

D1 = inner diameter	D2 = inner diameter 2	H = height	S = thickness	R = radius at top	Type of top	N = Number of notches
90.4mm	92.75 mm	246 mm	1.2 mm	R = 92 mm	All round	No notches

Materials (Housings d=90.4/92.7)

DC 05 EN 10130

Notes (Housings d=90.4/92.7)

The height of the housings is modifiable .

Housings without flange + i. diameter 103/107mm th. 1.2

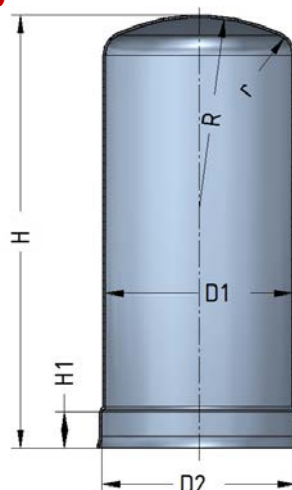

D1 = inner diameter	D2 = inner diameter 2	H = height	S = thickness	R = radius at top	Type of top	N = Number of notches
103.4 mm	107.6 mm	244 mm	1.2 mm	R = 106 mm	All round	No notches

Materials (Housings d=103/107)

DC 05 EN 10130

Notes (Housings d=103/107)

The height of the housings is modifiable .

Housings without flange + i. diam. 114/118 mm thick. 1.2

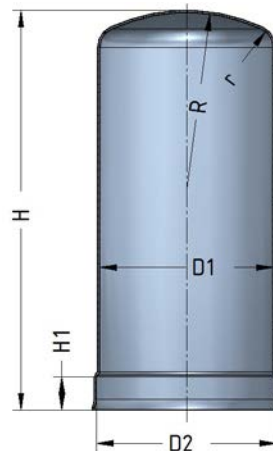

D1 = inner diameter	D2 = inner diameter 2	H = height	S = thickness	R = radius at top	Type of top	N = Number of notches
114.3 mm	118.6 mm	201.5 mm	1.2 mm	R=145 mm	22.5 mm	No notches
114.3 mm	118.6 mm	303 mm	1.2 mm	R = 145 mm	22.5 mm	No notches

Materials (Housings d=114/118)

DC 05 EN 10130

Notes (Housings d=114/118)

The height of the housings is modifiable .

Housings without flange + i. diam. 115/117mm thick. 1.2

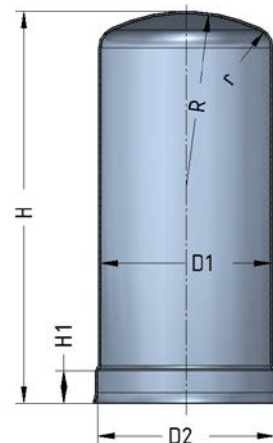

D1 = inner diameter	D2 = inner diameter 2	H = height	S = thickness	R = radius at top	Type of top	N = Number of notches
115 mm	117 mm	202 mm	1.2 mm	R = 100 mm	All round	No notches
115 mm	117 mm	302 mm	1.2 mm	R = 100 mm	All round	No notches
115 mm	117 mm	366 mm	1.2 mm	R = 100 mm	All round	No notches

Materials (Housings d=117/115)

DC 05 EN 10130

Notes (Housings d=117/115)

The height of the housings is modifiable .

Housings without flange + i. diam. 127 mm thick. 1.2mm

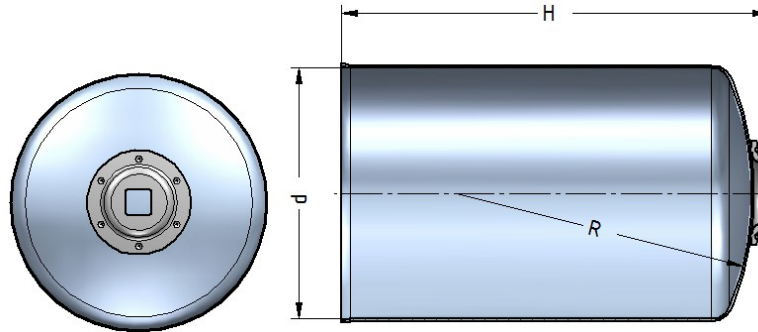

D1 = inner diameter		H = height	S = thickness	R = radius at top	Type of top	N = Number of notches
127 mm		217 mm	1.2 mm	R = 150 mm	All round	No notches

Materials (Housings d=127 sp. 1.2)

DC 05 EN 10130

Notes (Housings d=127 sp. 1.2)

The height of the housings is modifiable .

Housings without flange + i.d.=92 mm or i.d.=106.5 mm

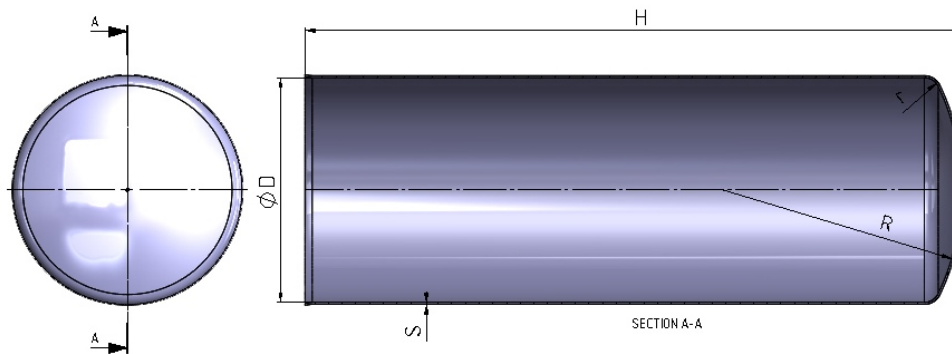

D1 = inner diameter		H = height	S = thickness	R = radius at top	Type of top	N = Number of notches
92.1 mm		270 mm	0.8 mm	R = 99 mm	All round	No notches
106.45 mm		259 mm	0.8 mm	R = 115.7 mm	All round	No notches

Materials (Housings no flangia d=92 e D=106.5)

DC 05 EN 10130

Notes (Housings no flangia d=92 e D=106.5)

The height of the housings is modifiable .

Housings without flange + inner diameter = 127

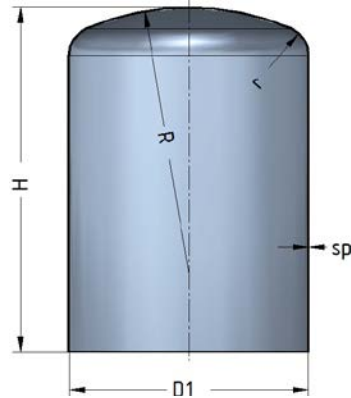

D1 = inner diameter	H = height	S = thickness	R = radius at top	Type of top	N = Number of notches
127 mm	182 mm	0.7 mm	R = 140 mm	All round	No notches
127 mm	275 mm	1.2 mm	R = 140 mm	All round	No notches

Materials (Housings no flangia d=127)

DC 05 EN 10130

Notes (Housings no flangia d=127)

The shapes of the housings can be changed (number of notches, radius at the bottom ...)
The height of the housings is modifiable .

Housings no flange + 2 i.diameters 125/127mm thick.=0.7

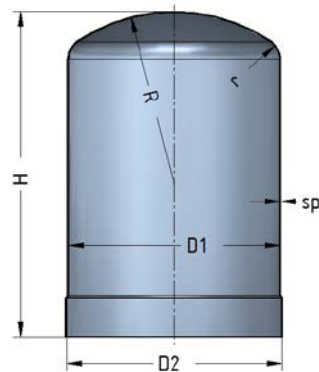

D1 = inner diameter	D2 = inner diameter 2	H = height	S = thickness	R = radius at top	Type of top	N = Number of notches
125 mm	127 mm	111 mm	0.5 mm	R = 102 mm	All round	No notches
125 mm	127 mm	170 mm	0.5 mm	R = 102 mm	All round	No notches
125 mm	127 mm	192 mm	0.5 mm	R = 102 mm	All round	No notches
125 mm	127 mm	222 mm	0.7 mm	R = 102 mm	All round	No notches
125 mm	127 mm	222 mm	0.7 mm	R = 102 mm	All round	No notches

Materials (Housings no flangia d=125/127)

DC 05 EN 10130

Notes (Housings no flangia d=125/127)

The shapes of the housings can be changed (number of notches, radius at the bottom ...)

The height of the housings is modifiable .

Housings 2 diameters 125/127mm thick. 0.5 (with flange)

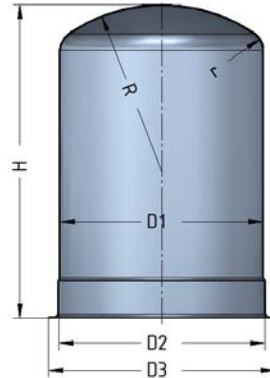

D1 = inner diameter	D2 = inner diameter 2	D3 = Flange diameter	H = height	S = thickness	R = Radius at top	N = Number of notches
125 mm	127 mm	140 mm	171.5 mm	0.5 mm	R = 102 mm	All round

Materials (Housings d=125/127)

DC 05 EN 10130

Notes (Housings d=125/127)

The shapes of the housings can be changed (number of notches, radius at the bottom ...)

The height of the housings is modifiable .

Housings with coaxial hole with collar

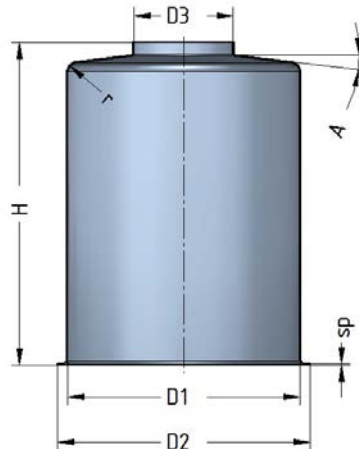

D1 = inner diameter	D2 = flange diameter 2	H = height	S = thickness		D3 = Hole of the top	
58 mm	66 mm	74 mm	0.7 mm		25 mm	
78.5 mm	85 mm	87 mm	0.7 mm		28 mm	
78.5 mm	85 mm	137 mm	0.7 mm		28 mm	
78.5 mm	85 mm	137 mm	0.7 mm		40 mm	
78.5 mm	86 mm	220 mm	0.7 mm		40 mm	
78.5 mm	86 mm	298 mm	0.7 / 0.8 mm		40 mm	
108 mm	125 mm	251 mm	0.8 mm		40 mm	
108 mm	125 mm	310 mm	0.8 mm		50 mm	
108 mm	125 mm	342 mm	0.8 mm		40 mm	
108 mm	125 mm	369 mm	0.8 mm		40 mm	
108 mm	125 mm	369 mm	0.8 mm		50 mm	
109.5 mm	118.6 mm	208 mm	0.7 mm		40 mm	
109.5 mm	118.6 mm	251 mm	0.7 mm		40 mm	
142 mm	154.5 mm	198 mm	0.7 mm		50 mm	
142 mm	154.5 mm	198 mm	0.7 mm		64 mm	
150 mm	162.8 mm	146 mm	0.7 mm		50 mm	
150 mm	162.8 mm	212 mm	0.7 mm		50 mm	
150 mm	162.8 mm	212 mm	0.7 mm		64 mm	
150 mm	162.8 mm	273 mm	0.7 mm		64 mm	

Materials (Housings with hole)

DC 05 EN 10130

DX54D+ZA130 EN 10346 (Galfan Z130)

Notes (Housings with hole)

The shapes of the housings can be changed (number of notches, radius at the bottom ...)

The height of the housings is modifiable .

Housings with diam. 80/85 mm, thick. 3, M85 threaded

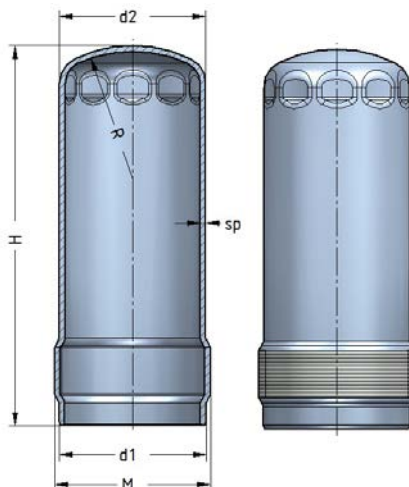

d1 = outer diameter	M = thread	d2 = body diameter	H = height	S = thickness	R = Radius at top	N = Number of notches
80 mm	M85x2	80 mm	125.2 mm	3 mm	R = 70 mm	10 flat notches
80 mm	M85x2	80 mm	158.5 mm	3 mm	R = 70 mm	10 flat notches
80 mm	M85x2	80 mm	208.5 mm	3 mm	R = 70 mm	10 flat notches
80 mm	M85x2	80 mm	307.5 mm	3 mm	R = 70 mm	10 flat notches

Materials (Housings d=80/85 sp=3)

DC 05 EN 10130 - Alluminio AL99.5

Notes (Housings d=80/85 sp=3)

The shapes of the housings can be changed (number of notches, radius at the bottom ...)
The height of the housings is modifiable .

Housings with diam. 90/94 mm thick. 2.5, M94 threaded

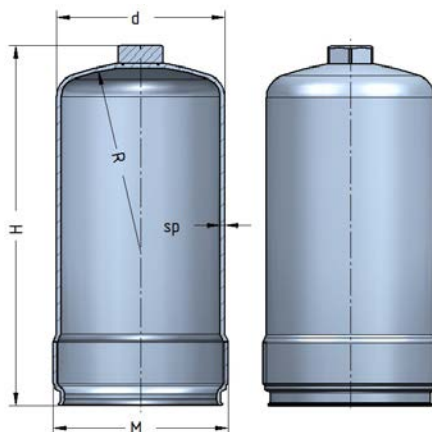

d1 = outer diameter	M = thread	Nut dimensions	H = height	S = thickness	R = Radius at top
90 mm	M94x1.5	CH 24 mm	135 mm	2.5 mm	R = 100 mm
90 mm	M94x1.5	CH 24 mm	194 mm	2.5 mm	R = 100 mm
90 mm	M94x1.5	CH 24 mm	275 mm	2.5 mm	R = 100 mm

Materials (Housings d=90/94 thick=2.5)

DC 05 EN 10130

Housings with diam. 95/100 mm thick 3, M100 threaded

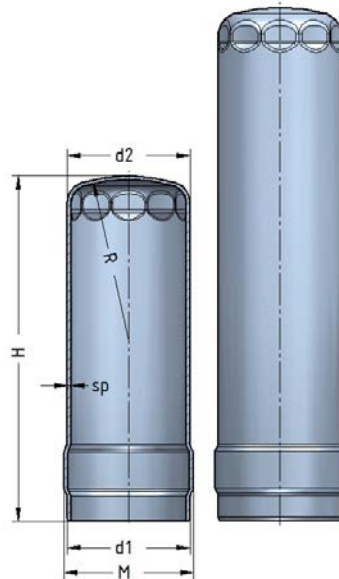

d1 = outer diameter	M = thread	d2 = body diameter	H = height	S = thickness	R = Radius at top	N = Number of notches
95 mm	M100x2	95 mm	178 mm	3 mm	R = 125 mm	10 flat notches
95 mm	M100x2	95 mm	268 mm	3 mm	R = 125 mm	10 flat notches
95 mm	M100x2	95 mm	398 mm	3 mm	R = 125 mm	10 flat notches
95 mm	M100x2	95 mm	418 mm	3 mm	R = 125 mm	10 flat notches
95 mm	M100x2	95 mm	536 mm	3 mm	R = 125 mm	10 flat notches

Materials (Housings d=95/100 thick.=3)

DC 05 EN 10130 - Alluminio

Notes (Housings d=95/100 thick.=3)

The shapes of the housings can be changed (number of notches, radius at the bottom ...)
The height of the housings is modifiable .

Housings with diam. 105/108 mm thick.2.5, M108 threaded

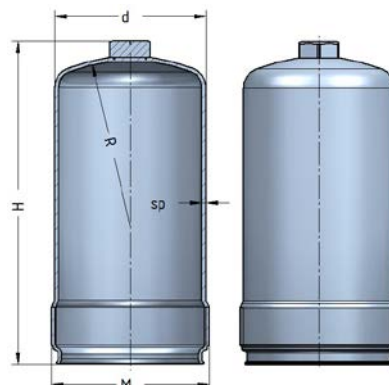

d1 = outer diameter	M = thread	Nut diemnsion	H = height	S = thickness	R = Radius at top	N = Number of notches
105 mm	M108x1.5	CH 24 mm	255 mm	2.5 mm	R = 100 mm	Proiezione

Materials (Housings d=90/94 sp=2)

DC 05 EN 10130

Housings with i.diam. 82 mm thick. 1.8

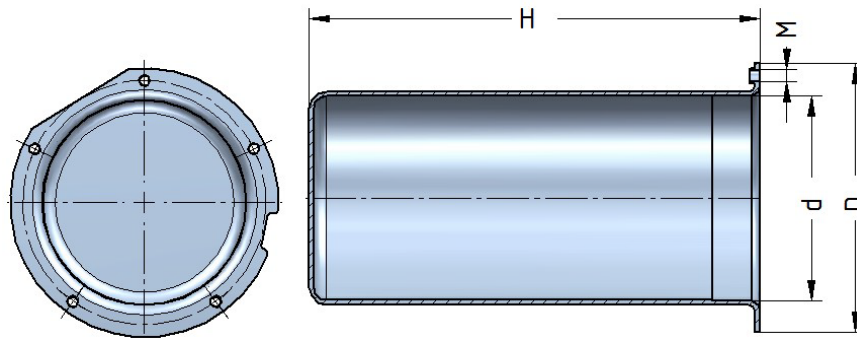

d = inner diameter	D = Flange diameter	M = threads	H = Total height	S = thcikness		
82 mm	108 mm	M5	182 mm	1.8 mm		

Materials (Housings d=82 thick=1.8)

DX54D+ZA200 EN10346 / DC05 EN10130

Notes (Housings d=82 thick.=1.8)

The shapes of the housings can be changed (number of notches, radius at the bottom ...)
 The height of the housings is modifiable .

Housings with i.diam. 82 mm thick. 1.8

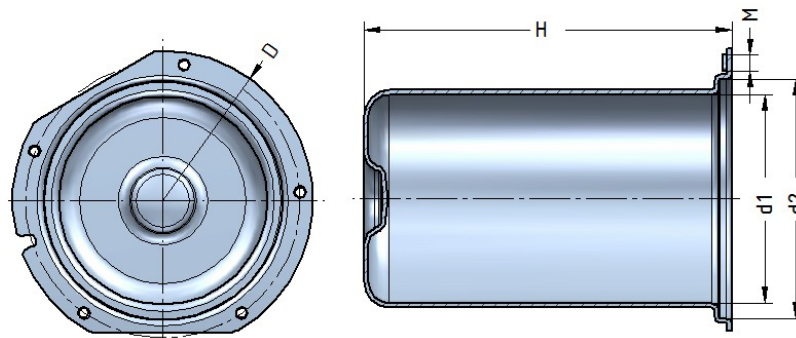

d1 = inner diameter	d2 = seat diameter	D = flange diameter	M = threads	H = Total height	S = thcikness	
82 mm	94 mm	108 mm	M5	144 mm	1.8 mm	

Materials (Housings d=82 thick.=1.8)

DX54D+ZA200 EN10346 / DC05 EN10130

Notes (Housings d=82 thick.=1.8)

The shapes of the housings can be changed (number of notches, radius at the bottom ...)
 The height of the housings is modifiable .

Housings with i.diam. 82 mm thick. 1.8

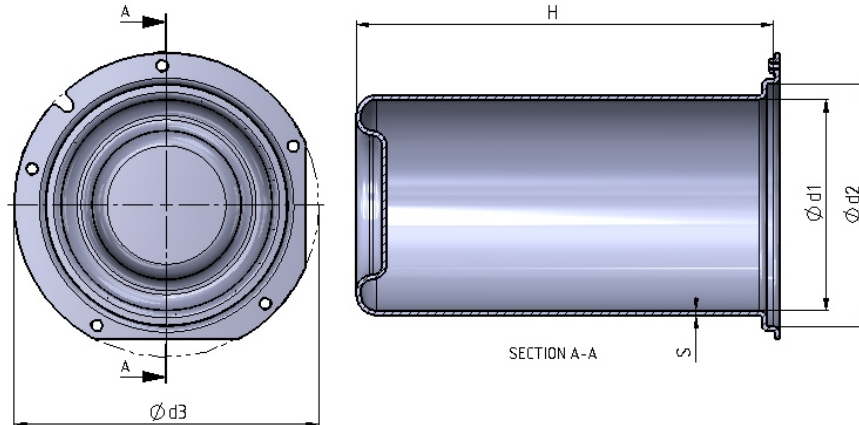

d1 = inner diameter	d2 = seat diameter	d3 = flange diameter	M = threads	H = Total height	S = thickness	
82 mm	94 mm	108 mm	M5	164 mm	1.8 mm	

Materials (Housings d=82 thick=1.8)

DX54D+ZA200 EN10346 / DC05 EN10130

Notes (Housings d=82 thick=1.8)

The shapes of the housings can be changed (number of notches, radius at the bottom ...)

The height of the housings is modifiable .

Housings with i.diam. 82 mm thick. 1.8

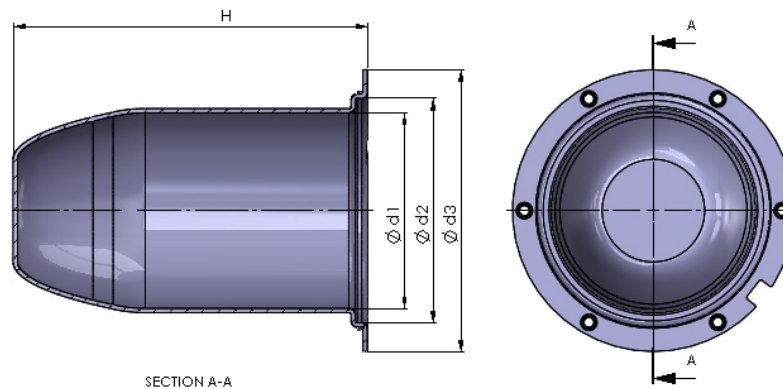

d1 = inner diameter	d2 = seat diameter	d3 = flange diameter	H = Total height	S = thickness	M threads	
82 mm	94 mm	118 mm	149 mm	1.8 mm	M5	

Materials (Housings d=82 thick.=1.8)

DX54D+ZA200 EN10346 / DC05 EN10130

Notes (Housings d=82 thick.=1.8)

The shapes of the housings can be changed (number of notches, radius at the bottom ...)

The height of the housings is modifiable .